

City of Fayetteville Staff Review Form

2017-0688

Legistar File ID

12/19/2017

City Council Meeting Date - Agenda Item Only
N/A for Non-Agenda Item

Chris Brown

12/1/2017

ENGINEERING (621)

Submitted By

Submitted Date

Division / Department

Action Recommendation:

A Resolution to award Bid #17-67 and approve a contract with Crossland Heavy Contractors, Inc. in the amount of \$5,574,726.35 for the construction of a portion of Ruppel Road between West Starry Night View and West Mount Comfort Road, to approve a project contingency in the amount of \$418,104.00, and to approve a Budget Adjustment to recognize additional federal-aid revenue of \$4,528,569, to consolidate funds from another Ruppel Road Project number, and to transfer water and sewer funds to the Ruppel Road project.

Budget Impact:

4470.800.8835-5809.00	Sales Tax Capital Improvement
4520.800.9556-5809.00	Sales Tax Construction Project
5400.720.5600-5808.00	Water and Sewer
Account Number	Fund
06035.3100	Ruppel Rd (BF Lane to Mt. Comfort)
Project Number	Project Title
Budgeted Item? Yes	Current Budget \$ 997,974.00
	Funds Obligated \$ 913,810.00
	Current Balance \$ 84,164.00
Does item have a cost? Yes	Item Cost \$ 5,992,830.00
Budget Adjustment Attached? Yes	Budget Adjustment \$ 5,992,830.00
	Remaining Budget \$ 84,164.00

V20140710

Previous Ordinance or Resolution # _____

Original Contract Number: _____

Approval Date: _____

Comments:



MEETING OF DECEMBER 19, 2017

TO: Mayor and City Council

THRU: Don Marr, Chief of Staff
Garner Stoll, Development Services Director
Chris Brown, City Engineer

FROM: Paul Libertini, Staff Engineer 

DATE: December 1, 2017

SUBJECT: **A Resolution to award Bid #17-67 and approve a contract with Crossland Heavy Contractors, Inc. in the amount of \$5,574,726.35 for the construction of a portion of Ruppel Road between West Starry Night View and West Mount Comfort Road, to approve a project contingency in the amount of \$418,104.00, and to approve a Budget Adjustment to recognize additional federal-aid revenue of \$4,528,569, to consolidate funds from another Ruppel Road Project number, and to transfer water and sewer funds to the Ruppel Road project**

RECOMMENDATION:

Staff recommends City Council approval awarding a contract in the amount of \$5,574,726.35 to Crossland Heavy Contractors, Inc. for the construction of a portion of Ruppel Road between West Starry Night View and West Mount Comfort Road, to approve a project contingency in the amount of \$418,104.00, and to approve a Budget Adjustment.

BACKGROUND:

On February 18, 2014, Garver entered a contract with the City for the design of Ruppel Road for a fee of \$352,879.00. The proposed improvements begin at the northern edge of the Starry Night View and proceed north approximately 1,700 linear feet to tie into the existing signalized intersection at Mount Comfort Road and Ruppel Road (existing northern leg of intersection). Environmental concerns, specifically historically significant artifacts, have delayed this project while staff and the consultant worked with State Historic Preservation Office (SHPO) to develop an acceptable mitigation plan.

On September 23, 2015, the NWARPC awarded this project an additional \$680,000 (80%) of Surface Transportation Program – Attributable (STP-A) funds with a City match of \$170,000 (20%) for a total of \$850,000 for FFY 2016. This funding is for the Environmental, Right Of Way and Utility phases of the Ruppel Road project.

The City received \$3,262,401 of Federal-aid from Surface Transportation Block Grant Program – Attributable (STBGP-A) for FFY 2017 and \$1,545,599 for FFY 2018. Total Federal-aid STBGP-A funding for this project is now \$5,774,303.00 with a City match of \$1,154,861.

DISCUSSION:

On November 29, 2017, the City received five (5) construction bids for this project. Crossland Heavy Contractors, Inc. submitted the low bid which was approximately 3% below the Engineer's Estimate of \$5,750,868. The highest bid was \$6,757,946.50.

Roadway & Bridge Improvements (Transportation Bond Fund) = \$4,979,102.35

Water & Sewer Improvements (W&S Fund) = \$595,624.00

Total Bid = \$5,574,726.35

BUDGET/STAFF IMPACT:

This project is based on an Agreement Of Understanding with AHTD in which Federal Aid money will pay 80% of the contract amount and the City will pay 20%. The Federal portion will be paid from the Surface Transportation Block Grant Program-Attributable (STBGP-A) funds. City matching funds for the roadway improvements will be from the Transportation Bond Program and Capital Improvements Program. City matching funds for the water & sewer improvements will be from the Water & Sewer Fund.

The total federal aid amount being recognized for this item is \$4,528,569. This amount is adequate to provide 80% funding for the contract bid amount; however, federal aid funds are not adequate to cover the full contingency amount. Therefore, the City's share of the overall cost of this item is approximately 25%, or \$1,464,261 of the total \$5,992,830 requested.

Attachments:

Garver letter of recommendation

Bid tabulation sheets

Bid Form – Document 00400 from Crossland Heavy Contractors

Construction Agreement – Document 00500

Funding letter from Northwest Arkansas Regional Planning Commission

Purchase Order (draft)



2049 E. Joyce Blvd.
Suite 400
Fayetteville, AR 72703
TEL 479.527.9100
FAX 479.527.9101
www.GarverUSA.com

November 30, 2017

Paul Libertini, P.E.
Staff Engineer
City of Fayetteville
113 West Mountain Street
Fayetteville, AR 72701

Re: **Recommendation of Award**
City of Fayetteville Bid 17-67
W. Starry Night View – W. Mount Comfort Rd. (N. Ruppel Rd)
ARDOT Job No. 040657
F.A.P. STPU-9142(36)

Dear Paul:

Bids were received for the “N. Ruppel Road” project at Fayetteville City Hall, 113 West Mountain Street, Fayetteville, Arkansas 72701 at 2:00 p.m. on Wednesday, November 29, 2017. The bids were checked for accuracy and for compliance with the contract documents. A tabulation of the bids received is enclosed with this letter.

A total of 5 bids were received on the project. Crossland Heavy Contractors, Inc. of Columbus, Kansas submitted the low bid for the project in the amount of \$5,574,726.35. The Engineer’s Opinion of Probable Cost was \$ 5,759,267.80.

We recommend that the City of Fayetteville award the construction contract for “N. Ruppel Road” to the low bidder, Crossland Heavy Contractors, Inc. We believe that the award of this project to Crossland Heavy Contractors, Inc. represents the best value for the City.

Please call me if you have any questions.

Sincerely,

GARVER, LLC

D. Jeffrey Webb, P.E.
Project Manager

Attachments: Bid Tabulation

\\garverinc.local\gdata\Projects\2009\09047100 - Ruppel Road Widening Relocation\Bidding\Recommendation of Award\Job 040657 - Recommendation to Award Letter.docm



Construction - Ruppel Rd. - Starry Night to Mt. Comfort

Bid No. 17-67
Official Bid Tabulation

Bid No. 17-67
Date: 11.29.2017
Time: 2:00 PM

Lionel Jordan, Mayor

Number of Addendums: 0

Certification of Funds: \$6,500,000.00
Max Bid Award Limit: \$8,125,000.00

ITEM NO.	CITY SPEC. NO.	DESCRIPTION	UNIT	ESTIMATED QTY.	Crossland Heavy Contractors, Inc.		Forsgren, Inc.		Ground Zero Construction, Inc.		Manhattan Road and Bridge Co.		Sweetser Construction, Inc.	
					UNIT PRICE	AMOUNT	UNIT PRICE	AMOUNT	UNIT PRICE	AMOUNT	UNIT PRICE	AMOUNT	UNIT PRICE	AMOUNT
1	111	Roadway Construction Control	LS	1	\$ 25,000.00	\$ 25,000.00	\$ 32,800.00	\$ 32,800.00	\$ 28,732.88	\$ 28,732.88	\$ 10,000.00	\$ 10,000.00	\$ 35,000.00	\$ 35,000.00
2	112	Trench & Excavation Safety Systems	LS	1	\$ 1,000.00	\$ 1,000.00	\$ 65,000.00	\$ 65,000.00	\$ 14,791.66	\$ 14,791.66	\$ 6,500.00	\$ 6,500.00	\$ 12,000.00	\$ 12,000.00
3	201	Clearing, Grubbing, and Demolition	LS	1	\$ 96,000.00	\$ 96,000.00	\$ 85,000.00	\$ 85,000.00	\$ 45,415.65	\$ 45,415.65	\$ 90,000.00	\$ 90,000.00	\$ 55,000.00	\$ 55,000.00
4	SP-14	Unclassified Excavation (Plan Quantity)	CY	11,824	\$ 9.00	\$ 106,416.00	\$ 16.25	\$ 192,140.00	\$ 3.00	\$ 35,472.00	\$ 12.00	\$ 141,888.00	\$ 8.00	\$ 94,592.00
5	SP-14	Embankment Construction (plan Quantity)	CY	33,167	\$ 12.75	\$ 422,879.25	\$ 17.85	\$ 592,030.95	\$ 13.55	\$ 449,412.85	\$ 12.00	\$ 398,004.00	\$ 8.50	\$ 281,919.50
6	SP-14	Undercut Excavation	CY	2,000	\$ 10.50	\$ 21,000.00	\$ 36.00	\$ 72,000.00	\$ 22.09	\$ 44,180.00	\$ 12.00	\$ 24,000.00	\$ 16.50	\$ 33,000.00
7	SP-14	Rock Excavation	CY	500	\$ 90.00	\$ 45,000.00	\$ 52.00	\$ 26,000.00	\$ 198.88	\$ 99,440.00	\$ 75.00	\$ 37,500.00	\$ 200.00	\$ 100,000.00
8	203	Subgrade Preparation (Plan Quantity)	SY	10,238	\$ 2.75	\$ 28,154.50	\$ 2.25	\$ 23,035.50	\$ 1.12	\$ 11,466.56	\$ 1.00	\$ 10,238.00	\$ 2.00	\$ 20,476.00
9	204	4" Topsoil Placement (Yard Areas)	SY	29,205	\$ 4.25	\$ 124,121.25	\$ 6.50	\$ 189,832.50	\$ 0.78	\$ 22,779.90	\$ 1.00	\$ 29,205.00	\$ 1.50	\$ 43,807.50
10	205	Undercut & Stone Backfill	Ton	5,000	\$ 34.50	\$ 172,500.00	\$ 42.65	\$ 213,250.00	\$ 25.69	\$ 128,450.00	\$ 21.00	\$ 105,000.00	\$ 19.00	\$ 95,000.00
11	301	18" Class III R.C. Pipe	LF	295	\$ 63.00	\$ 18,585.00	\$ 57.00	\$ 16,815.00	\$ 33.80	\$ 9,971.00	\$ 70.00	\$ 20,650.00	\$ 38.00	\$ 11,210.00
12	301	24" Class III R.C. Pipe	LF	274	\$ 82.00	\$ 22,468.00	\$ 69.00	\$ 18,906.00	\$ 41.60	\$ 11,398.40	\$ 80.00	\$ 21,920.00	\$ 54.00	\$ 14,796.00
13	301	30" Class III R.C. Pipe	LF	831	\$ 74.00	\$ 61,494.00	\$ 88.00	\$ 73,128.00	\$ 64.34	\$ 53,466.54	\$ 90.00	\$ 74,790.00	\$ 85.00	\$ 70,635.00
14	301	36" Class III R.C. Pipe	LF	786	\$ 117.00	\$ 91,962.00	\$ 125.00	\$ 98,250.00	\$ 88.28	\$ 69,388.08	\$ 110.00	\$ 86,460.00	\$ 120.00	\$ 94,320.00
15	301	53"x34" Class III R.C. Elliptical	LF	229	\$ 140.00	\$ 32,060.00	\$ 186.00	\$ 42,594.00	\$ 144.87	\$ 33,175.23	\$ 150.00	\$ 34,350.00	\$ 150.00	\$ 34,350.00
16	301	18" R.C. Flared End Section	EA	8	\$ 500.00	\$ 4,000.00	\$ 825.00	\$ 6,600.00	\$ 465.78	\$ 3,726.24	\$ 700.00	\$ 5,600.00	\$ 500.00	\$ 4,000.00
17	301	24" R.C. Flared End Section	EA	5	\$ 650.00	\$ 3,250.00	\$ 935.00	\$ 4,675.00	\$ 580.62	\$ 2,903.10	\$ 800.00	\$ 4,000.00	\$ 700.00	\$ 3,500.00
18	301	53"x34" R.C. Elliptical Flared End Section	EA	1	\$ 1,500.00	\$ 1,500.00	\$ 2,900.00	\$ 2,900.00	\$ 1,998.18	\$ 1,998.18	\$ 2,500.00	\$ 2,500.00	\$ 2,000.00	\$ 2,000.00
19	302	4' Drop Inlet (Type MO)	EA	1	\$ 3,150.00	\$ 3,150.00	\$ 3,450.00	\$ 3,450.00	\$ 2,830.61	\$ 2,830.61	\$ 4,500.00	\$ 4,500.00	\$ 3,200.00	\$ 3,200.00
20	302	5' Drop Inlet (Type MO)	EA	5	\$ 4,300.00	\$ 21,500.00	\$ 4,400.00	\$ 22,000.00	\$ 3,234.98	\$ 16,174.90	\$ 6,000.00	\$ 30,000.00	\$ 4,800.00	\$ 24,000.00
21	302	6' Drop Inlet (Type MO)	EA	2	\$ 5,500.00	\$ 11,000.00	\$ 5,450.00	\$ 10,900.00	\$ 3,928.18	\$ 7,856.36	\$ 6,500.00	\$ 13,000.00	\$ 5,400.00	\$ 10,800.00
22	302	5' Junction Box (Type MO)	EA	3	\$ 4,900.00	\$ 14,700.00	\$ 4,100.00	\$ 12,300.00	\$ 2,772.84	\$ 8,318.52	\$ 5,000.00	\$ 15,000.00	\$ 5,800.00	\$ 17,400.00
23	302	4' Drop Inlet Extension	EA	8	\$ 1,200.00	\$ 9,600.00	\$ 1,250.00	\$ 10,000.00	\$ 750.97	\$ 6,007.76	\$ 950.00	\$ 7,600.00	\$ 600.00	\$ 4,800.00
24	302	8' Drop Inlet Extension	EA	8	\$ 2,000.00	\$ 16,000.00	\$ 1,700.00	\$ 13,600.00	\$ 1,501.95	\$ 12,015.60	\$ 1,250.00	\$ 10,000.00	\$ 1,200.00	\$ 9,600.00
25	302	12' Drop Inlet Extension	EA	1	\$ 2,600.00	\$ 2,600.00	\$ 2,050.00	\$ 2,050.00	\$ 2,252.93	\$ 2,252.93	\$ 1,600.00	\$ 1,600.00	\$ 1,800.00	\$ 1,800.00
26	305	Channel Excavation (Plan Quantity)	CY	1,270	\$ 11.50	\$ 14,605.00	\$ 13.30	\$ 16,891.00	\$ 9.89	\$ 12,560.30	\$ 12.00	\$ 15,240.00	\$ 10.00	\$ 12,700.00
27	305	Concrete Channel Paving	SY	440	\$ 39.00	\$ 17,160.00	\$ 91.50	\$ 40,260.00	\$ 83.19	\$ 36,603.60	\$ 60.00	\$ 26,400.00	\$ 38.00	\$ 16,720.00
28	305	Erosion Control Fabric	SY	3,500	\$ 33.75	\$ 118,125.00	\$ 24.00	\$ 84,000.00	\$ 27.18	\$ 95,130.00	\$ 22.00	\$ 77,000.00	\$ 24.00	\$ 84,000.00

ITEM NO.	CITY SPEC. NO.	DESCRIPTION	UNIT	ESTIMATED QTY.	Crossland Heavy Contractors, Inc.		Forsgren, Inc.		Ground Zero Construction, Inc.		Manhattan Road and Bridge Co.		Sweetser Construction, Inc.	
					UNIT PRICE	AMOUNT	UNIT PRICE	AMOUNT	UNIT PRICE	AMOUNT	UNIT PRICE	AMOUNT	UNIT PRICE	AMOUNT
29	401	4" Aggregate Base Course	SY	3,127	\$ 9.25	\$ 28,924.75	\$ 7.75	\$ 24,234.25	\$ 5.77	\$ 18,042.79	\$ 6.00	\$ 18,762.00	\$ 6.00	\$ 18,762.00
30	401	8" Aggregate Base Course	SY	10,238	\$ 8.50	\$ 87,023.00	\$ 9.35	\$ 95,725.30	\$ 8.39	\$ 85,896.82	\$ 11.00	\$ 112,618.00	\$ 14.00	\$ 143,332.00
31	403	Asphalt Concrete Hot Mix Binder Course (ACHMBC)	Ton	2,250	\$ 71.00	\$ 159,750.00	\$ 73.70	\$ 165,825.00	\$ 67.65	\$ 152,212.50	\$ 67.00	\$ 150,750.00	\$ 64.90	\$ 146,025.00
32	403	Asphalt Concrete Hot Mix Surface Course (ACHMSC)	Ton	1,200	\$ 89.00	\$ 106,800.00	\$ 91.40	\$ 109,680.00	\$ 84.92	\$ 101,904.00	\$ 85.00	\$ 102,000.00	\$ 81.50	\$ 97,800.00
33	405	Asphalt Concrete Hot Mix Patching for Maintenance of Traffic	Ton	100	\$ 200.00	\$ 20,000.00	\$ 155.00	\$ 15,500.00	\$ 202.19	\$ 20,219.00	\$ 220.00	\$ 22,000.00	\$ 192.50	\$ 19,250.00
34	501	Concrete Curb and Gutter	LF	5,687	\$ 12.50	\$ 71,087.50	\$ 17.60	\$ 100,091.20	\$ 12.71	\$ 72,281.77	\$ 16.50	\$ 93,835.50	\$ 12.00	\$ 68,244.00
35	502	4" Thick Concrete Sidewalk	SY	1,158	\$ 38.25	\$ 44,293.50	\$ 38.80	\$ 44,930.40	\$ 37.50	\$ 43,425.00	\$ 46.00	\$ 53,268.00	\$ 38.00	\$ 44,004.00
36	502	6" Thick Concrete Sidewalk	SY	10	\$ 44.00	\$ 440.00	\$ 73.50	\$ 735.00	\$ 50.90	\$ 509.00	\$ 165.00	\$ 1,650.00	\$ 48.00	\$ 480.00
37	503	Concrete Driveway Aprons	SY	77	\$ 46.00	\$ 3,542.00	\$ 69.50	\$ 5,351.50	\$ 75.10	\$ 5,782.70	\$ 125.00	\$ 9,625.00	\$ 48.00	\$ 3,696.00
38	503	Asphalt Driveway	SY	1,161	\$ 21.50	\$ 24,961.50	\$ 33.50	\$ 38,893.50	\$ 13.64	\$ 15,836.04	\$ 21.00	\$ 24,381.00	\$ 13.00	\$ 15,093.00
39	503	Aggregate Base Course Driveway	SY	183	\$ 15.00	\$ 2,745.00	\$ 9.50	\$ 1,738.50	\$ 9.85	\$ 1,802.55	\$ 10.00	\$ 1,830.00	\$ 12.00	\$ 2,196.00
40	505	Seeding and Mulching	Acre	11	\$ 3,200.00	\$ 35,200.00	\$ 2,115.00	\$ 23,265.00	\$ 3,177.21	\$ 34,949.31	\$ 2,000.00	\$ 22,000.00	\$ 2,500.00	\$ 27,500.00
41	505	Solid Sod	SY	5,900	\$ 5.50	\$ 32,450.00	\$ 4.30	\$ 25,370.00	\$ 2.21	\$ 13,039.00	\$ 4.10	\$ 24,190.00	\$ 4.30	\$ 25,370.00
42	505	Additional Watering	MG	700	\$ 5.50	\$ 3,850.00	\$ 5.50	\$ 3,850.00	\$ 5.78	\$ 4,046.00	\$ 5.25	\$ 3,675.00	\$ 6.00	\$ 4,200.00
43	506	Mailbox Supports (single)	EA	3	\$ 120.00	\$ 360.00	\$ 175.00	\$ 525.00	\$ 404.37	\$ 1,213.11	\$ 360.00	\$ 1,080.00	\$ 385.00	\$ 1,155.00
44	506	Mailboxes	EA	3	\$ 120.00	\$ 360.00	\$ 75.00	\$ 225.00	\$ 404.37	\$ 1,213.11	\$ 360.00	\$ 1,080.00	\$ 385.00	\$ 1,155.00
45	507	4" Pavement Marking (Thermoplastic)	LF	9,250	\$ 1.45	\$ 13,412.50	\$ 1.40	\$ 12,950.00	\$ 1.44	\$ 13,320.00	\$ 1.30	\$ 12,025.00	\$ 1.40	\$ 12,950.00
46	507	6" Pavement Marking (Thermoplastic)	LF	743	\$ 1.45	\$ 1,077.35	\$ 1.40	\$ 1,040.20	\$ 1.44	\$ 1,069.92	\$ 1.30	\$ 965.90	\$ 1.40	\$ 1,040.20
47	507	12" Pavement Marking (Thermoplastic)	LF	724	\$ 11.50	\$ 8,326.00	\$ 11.00	\$ 7,964.00	\$ 11.55	\$ 8,362.20	\$ 10.20	\$ 7,384.80	\$ 11.00	\$ 7,964.00
48	507	Payment Symbols (Yield Line) (Thermoplastic)	SF	12	\$ 52.00	\$ 624.00	\$ 50.00	\$ 600.00	\$ 51.99	\$ 623.88	\$ 47.00	\$ 564.00	\$ 49.50	\$ 594.00
49	507	Pavement Symbols (Arrow) (Thermoplastic)	EA	15	\$ 466.00	\$ 6,990.00	\$ 440.00	\$ 6,600.00	\$ 462.14	\$ 6,932.10	\$ 410.00	\$ 6,150.00	\$ 440.00	\$ 6,600.00
50	507	Pavement Symbols (ONLY) (Thermoplastic)	EA	12	\$ 400.00	\$ 4,800.00	\$ 385.00	\$ 4,620.00	\$ 404.37	\$ 4,852.44	\$ 360.00	\$ 4,320.00	\$ 385.00	\$ 4,620.00
51	507	4" Pavement Marking (ReflectORIZED Paint)	LF	849	\$ 4.50	\$ 3,820.50	\$ 4.40	\$ 3,735.60	\$ 4.62	\$ 3,922.38	\$ 4.20	\$ 3,565.80	\$ 4.40	\$ 3,735.60
52	507	Pavement Marking Removal	SF	196	\$ 1.45	\$ 284.20	\$ 1.40	\$ 274.40	\$ 1.44	\$ 282.24	\$ 1.30	\$ 254.80	\$ 1.40	\$ 274.40
53	508	Street Sign Installation	EA	16	\$ 700.00	\$ 11,200.00	\$ 660.00	\$ 10,560.00	\$ 693.20	\$ 11,091.20	\$ 620.00	\$ 9,920.00	\$ 660.00	\$ 10,560.00
54	509	Erosion Control	LS	1	\$ 30,000.00	\$ 30,000.00	\$ 22,000.00	\$ 22,000.00	\$ 47,551.61	\$ 47,551.61	\$ 20,000.00	\$ 20,000.00	\$ 22,000.00	\$ 22,000.00
55	510	Traffic Control and Maintenance	LS	1	\$ 10,000.00	\$ 10,000.00	\$ 65,000.00	\$ 65,000.00	\$ 30,776.48	\$ 30,776.48	\$ 30,000.00	\$ 30,000.00	\$ 37,500.00	\$ 37,500.00
56	511	Mobilization (not to exceed 5% of contract price)	LS	1	\$ 102,500.00	\$ 102,500.00	\$ 330,000.00	\$ 330,000.00	\$ 99,359.94	\$ 99,359.94	\$ 200,000.00	\$ 200,000.00	\$ 211,600.00	\$ 211,600.00
57	512	Barbed Wire Fence	LF	2,119	\$ 7.25	\$ 15,362.75	\$ 5.35	\$ 11,336.65	\$ 3.99	\$ 8,454.81	\$ 5.00	\$ 10,595.00	\$ 8.25	\$ 17,481.75
58	512	Wood Privacy Fence	LF	200	\$ 27.00	\$ 5,400.00	\$ 38.50	\$ 7,700.00	\$ 28.89	\$ 5,778.00	\$ 36.00	\$ 7,200.00	\$ 38.50	\$ 7,700.00
59	512	Gates for Wood Privacy Fence	LF	20	\$ 42.00	\$ 840.00	\$ 385.00	\$ 7,700.00	\$ 60.66	\$ 1,213.20	\$ 125.00	\$ 2,500.00	\$ 350.00	\$ 7,000.00
60	512	Temporary Fencing	LF	2,119	\$ 7.25	\$ 15,362.75	\$ 3.00	\$ 6,357.00	\$ 3.00	\$ 6,357.00	\$ 2.80	\$ 5,933.20	\$ 8.25	\$ 17,481.75
61	513	Cast-in-Place Detectable Warning Panel	SF	118	\$ 18.00	\$ 2,124.00	\$ 28.00	\$ 3,304.00	\$ 40.43	\$ 4,770.74	\$ 20.00	\$ 2,360.00	\$ 15.00	\$ 1,770.00
62	513	Handicap Access Ramp	SY	87	\$ 34.00	\$ 2,958.00	\$ 69.50	\$ 6,046.50	\$ 75.10	\$ 6,533.70	\$ 83.00	\$ 7,221.00	\$ 56.00	\$ 4,872.00
63	514	Project Sign	EA	2	\$ 850.00	\$ 1,700.00	\$ 825.00	\$ 1,650.00	\$ 866.52	\$ 1,733.04	\$ 1,000.00	\$ 2,000.00	\$ 825.00	\$ 1,650.00

ITEM NO.	CITY SPEC. NO.	DESCRIPTION	UNIT	ESTIMATED QTY.	Crossland Heavy Contractors, Inc.		Forsgren, Inc.		Ground Zero Construction, Inc.		Manhattan Road and Bridge Co.		Sweetser Construction, Inc.	
					UNIT PRICE	AMOUNT	UNIT PRICE	AMOUNT	UNIT PRICE	AMOUNT	UNIT PRICE	AMOUNT	UNIT PRICE	AMOUNT
64	516	Cold Milling Asphalt Pavement	SY	1,600	\$ 8.00	\$ 12,800.00	\$ 8.00	\$ 12,800.00	\$ 4.62	\$ 7,392.00	\$ 7.50	\$ 12,000.00	\$ 4.40	\$ 7,040.00
65	517	Tree Protection Fencing	LF	400	\$ 2.00	\$ 800.00	\$ 4.75	\$ 1,900.00	\$ 5.18	\$ 2,072.00	\$ 4.50	\$ 1,800.00	\$ 5.00	\$ 2,000.00
66	SP-3	Trail Sign Installation	EA	1	\$ 1,900.00	\$ 1,900.00	\$ 825.00	\$ 825.00	\$ 750.97	\$ 750.97	\$ 1,000.00	\$ 1,000.00	\$ 400.00	\$ 400.00
67	SP-4	Concrete Island	SY	197	\$ 44.00	\$ 8,668.00	\$ 53.00	\$ 10,441.00	\$ 75.10	\$ 14,794.70	\$ 50.00	\$ 9,850.00	\$ 48.00	\$ 9,456.00
68	SP-5	4" Thick Concrete Trail	SY	2,614	\$ 39.00	\$ 101,946.00	\$ 39.50	\$ 103,253.00	\$ 37.27	\$ 97,423.78	\$ 50.00	\$ 130,700.00	\$ 49.00	\$ 128,086.00
69	SP-5	6" Thick Concrete Trail	SY	20	\$ 43.00	\$ 860.00	\$ 65.00	\$ 1,300.00	\$ 47.77	\$ 955.40	\$ 135.00	\$ 2,700.00	\$ 56.00	\$ 1,120.00
70	SP-6	Gravity Block Retaining Wall #1 (Plan Quantity)	SF	341	\$ 55.00	\$ 18,755.00	\$ 140.00	\$ 47,740.00	\$ 89.54	\$ 30,533.14	\$ 125.00	\$ 42,625.00	\$ 81.50	\$ 27,791.50
71	SP-6	Gravity Block Retaining Wall #2 (Plan Quantity)	SF	2,546	\$ 55.00	\$ 140,030.00	\$ 72.00	\$ 183,312.00	\$ 89.54	\$ 227,968.84	\$ 65.00	\$ 165,490.00	\$ 81.50	\$ 207,499.00
72	SP-6	Gravity Block Retaining Wall #3 (Plan Quantity)	SF	4,701	\$ 55.00	\$ 258,555.00	\$ 82.00	\$ 385,482.00	\$ 89.54	\$ 420,927.54	\$ 65.00	\$ 305,565.00	\$ 81.50	\$ 383,131.50
73	SP-6	Gravity Block Retaining Wall #4 (Plan Quantity)	SF	6,018	\$ 55.00	\$ 330,990.00	\$ 77.50	\$ 466,395.00	\$ 89.54	\$ 538,851.72	\$ 65.00	\$ 391,170.00	\$ 81.50	\$ 490,467.00
74	SP-7	Pipe Underdrain	LF	800	\$ 7.00	\$ 5,600.00	\$ 15.50	\$ 12,400.00	\$ 13.94	\$ 11,152.00	\$ 8.00	\$ 6,400.00	\$ 1.00	\$ 800.00
75	SP-9	5'x5' Special Deep Drop Inlet	EA	4	\$ 9,800.00	\$ 39,200.00	\$ 7,950.00	\$ 31,800.00	\$ 4,043.71	\$ 16,174.84	\$ 12,000.00	\$ 48,000.00	\$ 6,200.00	\$ 24,800.00
76	SP-9	7'x7' Special Deep Drop Inlet	EA	1	\$ 12,000.00	\$ 12,000.00	\$ 12,850.00	\$ 12,850.00	\$ 5,083.53	\$ 5,083.53	\$ 17,500.00	\$ 17,500.00	\$ 8,800.00	\$ 8,800.00
77	SP-9	4'x5' Reverse Throat Inlet	EA	3	\$ 4,000.00	\$ 12,000.00	\$ 5,100.00	\$ 15,300.00	\$ 3,697.11	\$ 11,091.33	\$ 7,000.00	\$ 21,000.00	\$ 4,800.00	\$ 14,400.00
78	SP-9	Modify Existing 5' Deep Drop Inlet	EA	1	\$ 2,500.00	\$ 2,500.00	\$ 1,650.00	\$ 1,650.00	\$ 2,310.69	\$ 2,310.69	\$ 6,000.00	\$ 6,000.00	\$ 4,200.00	\$ 4,200.00
79	SP-12	Decorative Fence	LF	1,600	\$ 65.00	\$ 104,000.00	\$ 52.00	\$ 83,200.00	\$ 76.37	\$ 122,192.00	\$ 48.00	\$ 76,800.00	\$ 51.70	\$ 82,720.00
80	SP-13	Decorative Gravel (6" Depth)	SY	356	\$ 14.00	\$ 4,984.00	\$ 32.00	\$ 11,392.00	\$ 6.33	\$ 2,253.48	\$ 17.00	\$ 6,052.00	\$ 24.00	\$ 8,544.00
81	SP-16	Bridge Construction Control	LS	1	\$ 22,000.00	\$ 22,000.00	\$ 6,050.00	\$ 6,050.00	\$ 6,354.42	\$ 6,354.42	\$ 5,600.00	\$ 5,600.00	\$ 5,775.00	\$ 5,775.00
82	SP-16	Unclassified Excavation for Structures - Bridge	CY	409	\$ 60.00	\$ 24,540.00	\$ 66.00	\$ 26,994.00	\$ 69.32	\$ 28,351.88	\$ 60.00	\$ 24,540.00	\$ 63.00	\$ 25,767.00
83	SP-16	Rock Excavation for Structures - Bridge	CY	97	\$ 160.00	\$ 15,520.00	\$ 195.00	\$ 18,915.00	\$ 202.19	\$ 19,612.43	\$ 175.00	\$ 16,975.00	\$ 184.00	\$ 17,848.00
84	SP-16	Class 5 Concrete - Bridge	CY	495	\$ 522.00	\$ 258,390.00	\$ 715.00	\$ 353,925.00	\$ 750.97	\$ 371,730.15	\$ 600.00	\$ 297,000.00	\$ 682.50	\$ 337,837.50
85	SP-16	Class 5(AE) Concrete - Bridge	CY	410	\$ 588.00	\$ 241,080.00	\$ 525.00	\$ 215,250.00	\$ 548.79	\$ 225,003.90	\$ 475.00	\$ 194,750.00	\$ 498.75	\$ 204,487.50
86	SP-16	Class 2 Protective Surface Treatment	SY	1,717	\$ 4.50	\$ 7,726.50	\$ 5.25	\$ 9,014.25	\$ 5.43	\$ 9,323.31	\$ 4.70	\$ 8,069.90	\$ 4.95	\$ 8,499.15
87	SP-16	Reinforcing Steel - Bridge (Grade 60)	LB	55,570	\$ 0.85	\$ 47,234.50	\$ 1.10	\$ 61,127.00	\$ 1.16	\$ 64,461.20	\$ 1.00	\$ 55,570.00	\$ 1.05	\$ 58,348.50
88	SP-16	Epoxy Coated Reinforcing Steel (Grade 60)	LB	120,670	\$ 0.90	\$ 108,603.00	\$ 1.10	\$ 132,737.00	\$ 1.16	\$ 139,977.20	\$ 1.10	\$ 132,737.00	\$ 1.05	\$ 126,703.50
89	SP-16	Transitional Approach Railing	EA	4	\$ 3,500.00	\$ 14,000.00	\$ 4,620.00	\$ 18,480.00	\$ 4,852.46	\$ 19,409.84	\$ 4,000.00	\$ 16,000.00	\$ 4,410.00	\$ 17,640.00
90	SP-16	Structural Steel in Plate Girder Spans (M270-GR. S0W)	LB	373,280	\$ 1.88	\$ 701,766.40	\$ 2.05	\$ 765,224.00	\$ 2.15	\$ 802,552.00	\$ 1.80	\$ 671,904.00	\$ 1.95	\$ 727,896.00
91	SP-16	Elastomeric Bearings	CUIN	12,192	\$ 2.45	\$ 29,870.40	\$ 2.50	\$ 30,480.00	\$ 2.60	\$ 31,699.20	\$ 2.50	\$ 30,480.00	\$ 2.35	\$ 28,651.20
92	SP-16	Silicone Joint Sealant	LF	141	\$ 52.00	\$ 7,332.00	\$ 66.00	\$ 9,306.00	\$ 69.32	\$ 9,774.12	\$ 50.00	\$ 7,050.00	\$ 63.00	\$ 8,883.00
93	SP-16	Filter Blanket	SY	262	\$ 8.00	\$ 2,096.00	\$ 6.60	\$ 1,729.20	\$ 6.93	\$ 1,815.66	\$ 5.00	\$ 1,310.00	\$ 6.30	\$ 1,650.60
94	SP-16	Dumped Riprap	CY	272	\$ 58.00	\$ 15,776.00	\$ 72.00	\$ 19,584.00	\$ 73.94	\$ 20,111.68	\$ 60.00	\$ 16,320.00	\$ 67.20	\$ 18,278.40
95	SP-17	Steel Piling (HP12X53)	LF	165	\$ 73.00	\$ 12,045.00	\$ 100.00	\$ 16,500.00	\$ 103.98	\$ 17,156.70	\$ 100.00	\$ 16,500.00	\$ 94.50	\$ 15,592.50
96	SP-18	Metal Bridge Railing (Type H2)	LF	179	\$ 67.00	\$ 11,993.00	\$ 85.80	\$ 15,358.20	\$ 90.11	\$ 16,129.69	\$ 75.00	\$ 13,425.00	\$ 81.90	\$ 14,660.10
97	SP-19	Preboring	LF	110	\$ 250.00	\$ 27,500.00	\$ 165.00	\$ 18,150.00	\$ 173.30	\$ 19,063.00	\$ 150.00	\$ 16,500.00	\$ 157.50	\$ 17,325.00
98	SP-20	Textured Coating Finish	SY	393	\$ 8.25	\$ 3,242.25	\$ 14.30	\$ 5,619.90	\$ 15.02	\$ 5,902.86	\$ 13.00	\$ 5,109.00	\$ 13.65	\$ 5,364.45
99	305	Concrete Channell Paving with Vertical Retaining Walls	SY	60	\$ 140.00	\$ 8,400.00	\$ 180.00	\$ 10,800.00	\$ 404.37	\$ 24,262.20	\$ 95.00	\$ 5,700.00	\$ 234.00	\$ 14,040.00
U1	1000	Construction Staking for Water & Sewer	LS	1	\$ 7,750.00	\$ 7,750.00	\$ 9,500.00	\$ 9,500.00	\$ 5,776.74	\$ 5,776.74	\$ 4,500.00	\$ 4,500.00	\$ 3,500.00	\$ 3,500.00

ITEM NO.	CITY SPEC. NO.	DESCRIPTION	UNIT	ESTIMATED QTY.	Crossland Heavy Contractors, Inc.		Forsgren, Inc.		Ground Zero Construction, Inc.		Manhattan Road and Bridge Co.		Sweetser Construction, Inc.	
					UNIT PRICE	AMOUNT	UNIT PRICE	AMOUNT	UNIT PRICE	AMOUNT	UNIT PRICE	AMOUNT	UNIT PRICE	AMOUNT
U2	1000	Traffic Control and Maintenance for Water & Sewer	LS	1	\$ 1,500.00	\$ 1,500.00	\$ 7,600.00	\$ 7,600.00	\$ 13,994.88	\$ 13,994.88	\$ 4,100.00	\$ 4,100.00	\$ 5,000.00	\$ 5,000.00
U3	1000	Wastewater Bypass Pumping	LS	1	\$ 9,000.00	\$ 9,000.00	\$ 10,000.00	\$ 10,000.00	\$ 23,687.97	\$ 23,687.97	\$ 10,200.00	\$ 10,200.00	\$ 7,500.00	\$ 7,500.00
U4	1000	Bonds & Insurance	LS	1	\$ 8,000.00	\$ 8,000.00	\$ 50,000.00	\$ 50,000.00	\$ 52,106.20	\$ 52,106.20	\$ 7,500.00	\$ 7,500.00	\$ 5,000.00	\$ 5,000.00
U5	2000	Trench & Excavation Safety Systems for Water & Sewer	LS	1	\$ 3,500.00	\$ 3,500.00	\$ 7,500.00	\$ 7,500.00	\$ 5,717.72	\$ 5,717.72	\$ 11,100.00	\$ 11,100.00	\$ 3,500.00	\$ 3,500.00
U6	2100	Erosion Control for Water & Sewer	LS	1	\$ 7,500.00	\$ 7,500.00	\$ 10,000.00	\$ 10,000.00	\$ 1,275.48	\$ 1,275.48	\$ 3,100.00	\$ 3,100.00	\$ 4,400.00	\$ 4,400.00
U7	2100	Dewatering	LS	1	\$ 11,500.00	\$ 11,500.00	\$ 6,200.00	\$ 6,200.00	\$ 20,659.46	\$ 20,659.46	\$ 4,100.00	\$ 4,100.00	\$ 5,000.00	\$ 5,000.00
U8	2100	Mitigation Dam	EA	2	\$ 1,500.00	\$ 3,000.00	\$ 600.00	\$ 1,200.00	\$ 3,035.85	\$ 6,071.70	\$ 1,300.00	\$ 2,600.00	\$ 3,500.00	\$ 7,000.00
U9	2200	Clearing, Grubbing, and Demolition for Water & Sewer	LS	1	\$ 7,500.00	\$ 7,500.00	\$ 5,200.00	\$ 5,200.00	\$ 8,575.65	\$ 8,575.65	\$ 5,200.00	\$ 5,200.00	\$ 500.00	\$ 500.00
U10	2300	Undercut and Backfill for Water & Sewer	CY	50	\$ 31.00	\$ 1,550.00	\$ 30.00	\$ 1,500.00	\$ 68.93	\$ 3,446.50	\$ 52.00	\$ 2,600.00	\$ 25.00	\$ 1,250.00
U11	2300	Rock Excavation for Water & Sewer	CY	500	\$ 225.00	\$ 112,500.00	\$ 125.00	\$ 62,500.00	\$ 224.49	\$ 112,245.00	\$ 155.00	\$ 77,500.00	\$ 200.00	\$ 100,000.00
U12	2300	Flowable Fill for Abandoned Pipelines	LF	1,435	\$ 9.00	\$ 12,915.00	\$ 6.50	\$ 9,327.50	\$ 6.04	\$ 8,667.40	\$ 10.00	\$ 14,350.00	\$ 5.00	\$ 7,175.00
U13	2300	Backfill Density Test	EA	10	\$ 170.00	\$ 1,700.00	\$ 60.00	\$ 600.00	\$ 207.97	\$ 2,079.70	\$ 260.00	\$ 2,600.00	\$ 150.00	\$ 1,500.00
U14	3000	Sewer Service Line	LF	50	\$ 22.00	\$ 1,100.00	\$ 45.50	\$ 2,275.00	\$ 23.59	\$ 1,179.50	\$ 26.00	\$ 1,300.00	\$ 50.00	\$ 2,500.00
U15	3000	Connect Sewer Service	EA	1	\$ 325.00	\$ 325.00	\$ 325.00	\$ 325.00	\$ 997.47	\$ 997.47	\$ 410.00	\$ 410.00	\$ 1,000.00	\$ 1,000.00
U16	3000	10" PVC Sewer Line	LF	239	\$ 51.00	\$ 12,189.00	\$ 60.00	\$ 14,340.00	\$ 30.22	\$ 7,222.58	\$ 83.00	\$ 19,837.00	\$ 45.00	\$ 10,755.00
U17	3300	4' ID Manhole, 0' to 6' Depth	EA	3	\$ 2,250.00	\$ 6,750.00	\$ 2,900.00	\$ 8,700.00	\$ 1,790.79	\$ 5,372.37	\$ 2,700.00	\$ 8,100.00	\$ 2,800.00	\$ 8,400.00
U18	3300	4' ID Manhole Additional Depth, Over 6'	VF	6	\$ 220.00	\$ 1,320.00	\$ 195.00	\$ 1,170.00	\$ 173.30	\$ 1,039.80	\$ 180.00	\$ 1,080.00	\$ 150.00	\$ 900.00
U19	3300	Demolish Existing Manhole	EA	1	\$ 1,100.00	\$ 1,100.00	\$ 600.00	\$ 600.00	\$ 480.58	\$ 480.58	\$ 2,600.00	\$ 2,600.00	\$ 500.00	\$ 500.00
U20	S18	Reinforced Flexible Coupling	EA	1	\$ 190.00	\$ 190.00	\$ 325.00	\$ 325.00	\$ 325.96	\$ 325.96	\$ 458.00	\$ 458.00	\$ 500.00	\$ 500.00
U21	3300	Modify Sewer Invert	EA	1	\$ 500.00	\$ 500.00	\$ 560.00	\$ 560.00	\$ 987.12	\$ 987.12	\$ 1,800.00	\$ 1,800.00	\$ 1,200.00	\$ 1,200.00
U22	3400	24" Bored Steel Encasement for Water Line	LF	135	\$ 840.00	\$ 113,400.00	\$ 565.00	\$ 76,275.00	\$ 436.66	\$ 58,949.10	\$ 750.00	\$ 101,250.00	\$ 800.00	\$ 108,000.00
U23	4000	Fire Hydrant Assembly	EA	2	\$ 4,600.00	\$ 9,200.00	\$ 4,000.00	\$ 8,000.00	\$ 4,888.69	\$ 9,777.38	\$ 5,300.00	\$ 10,600.00	\$ 4,800.00	\$ 9,600.00
U24	4000	12" Ductile Iron Water Line (Class 350)	F 1844	1,840	\$ 98.00	\$ 180,320.00	\$ 73.00	\$ 134,320.00	\$ 41.85	\$ 77,004.00	\$ 72.00	\$ 132,480.00	\$ 65.00	\$ 119,600.00
U25	4000	8" Ductile Iron Water Line (Class 350)	LF 95	95	\$ 85.00	\$ 8,075.00	\$ 60.00	\$ 5,700.00	\$ 31.06	\$ 2,950.70	\$ 78.00	\$ 7,410.00	\$ 60.00	\$ 5,700.00
U26	4000	Ductile Iron Fittings	EA	1,865	\$ 11.00	\$ 20,515.00	\$ 11.50	\$ 21,447.50	\$ 12.07	\$ 22,510.55	\$ 17.50	\$ 32,637.50	\$ 14.50	\$ 27,042.50
U27	4000	12"x12" Tapping Sleeve & Valve	EA	2	\$ 6,900.00	\$ 13,800.00	\$ 7,750.00	\$ 15,500.00	\$ 5,549.05	\$ 11,098.10	\$ 7,200.00	\$ 14,400.00	\$ 6,900.00	\$ 13,800.00
U28	4000	12" Gate Valve	EA	1	\$ 2,650.00	\$ 2,650.00	\$ 2,800.00	\$ 2,800.00	\$ 2,753.02	\$ 2,753.02	\$ 3,800.00	\$ 3,800.00	\$ 4,500.00	\$ 4,500.00
U29	4000	Water Meter Setting	EA	2	\$ 940.00	\$ 1,880.00	\$ 325.00	\$ 650.00	\$ 688.88	\$ 1,377.76	\$ 2,100.00	\$ 4,200.00	\$ 950.00	\$ 1,900.00
U30	4000	Water Service Line	LF	172	\$ 25.00	\$ 4,300.00	\$ 28.00	\$ 4,816.00	\$ 12.85	\$ 2,210.20	\$ 16.00	\$ 2,752.00	\$ 8.00	\$ 1,376.00
U31	4100	Cut & Cap Existing 12" PVC Water Line	EA	4	\$ 1,400.00	\$ 5,600.00	\$ 1,600.00	\$ 6,400.00	\$ 1,257.56	\$ 5,030.24	\$ 2,600.00	\$ 10,400.00	\$ 800.00	\$ 3,200.00
U32	4100	Cut & Cap Existing 12" PVC Water Line	EA	1	\$ 1,800.00	\$ 1,800.00	\$ 1,650.00	\$ 1,650.00	\$ 1,528.10	\$ 1,528.10	\$ 2,900.00	\$ 2,900.00	\$ 800.00	\$ 800.00
U33	5200	Concrete Test	EA	2	\$ 150.00	\$ 300.00	\$ 175.00	\$ 350.00	\$ 207.97	\$ 415.94	\$ 260.00	\$ 520.00	\$ 500.00	\$ 1,000.00
U34	S11	Core Drill & Connect to Existing Manhole	EA	1	\$ 1,000.00	\$ 1,000.00	\$ 1,750.00	\$ 1,750.00	\$ 1,489.76	\$ 1,489.76	\$ 2,600.00	\$ 2,600.00	\$ 1,200.00	\$ 1,200.00
U35	S12	Adjust Existing Manhole to Finished Grade	EA	1	\$ 2,150.00	\$ 2,150.00	\$ 850.00	\$ 850.00	\$ 254.69	\$ 254.69	\$ 2,200.00	\$ 2,200.00	\$ 2,500.00	\$ 2,500.00

ITEM NO.	CITY SPEC. NO.	DESCRIPTION	UNIT	ESTIMATED QTY.	Crossland Heavy Contractors, Inc.		Forsgren, Inc.		Ground Zero Construction, Inc.		Manhattan Road and Bridge Co.		Sweetser Construction, Inc.	
					UNIT PRICE	AMOUNT	UNIT PRICE	AMOUNT	UNIT PRICE	AMOUNT	UNIT PRICE	AMOUNT	UNIT PRICE	AMOUNT
U36	S13	Abandon Existing Manhole	EA	1	\$ 900.00	\$ 900.00	\$ 900.00	\$ 900.00	\$ 1,172.87	\$ 1,172.87	\$ 1,600.00	\$ 1,600.00	\$ 1,000.00	\$ 1,000.00
U37	W20	2" Blowoff Assembly	EA	1	\$ 3,500.00	\$ 3,500.00	\$ 3,350.00	\$ 3,350.00	\$ 1,544.24	\$ 1,544.24	\$ 2,200.00	\$ 2,200.00	\$ 900.00	\$ 900.00
U38	4100	Adjust Existing Valve Box to Finished Grade	EA	2	\$ 500.00	\$ 1,000.00	\$ 165.00	\$ 330.00	\$ 292.97	\$ 585.94	\$ 260.00	\$ 520.00	\$ 500.00	\$ 1,000.00
U39	3400	24" Open Cut Steel Encasement for Water Line	LF	71	\$ 195.00	\$ 13,845.00	\$ 146.00	\$ 10,366.00	\$ 131.71	\$ 9,351.41	\$ 175.00	\$ 12,425.00	\$ 220.00	\$ 15,620.00
Sub Total Amount of Bid for Roadway (Items 1-98)					\$	4,979,102.35	\$	6,253,069.50	\$	5,445,895.83	\$	5,058,840.90	\$	5,242,784.10
Sub Total Amount of Bid for Water & Sanitary Sewer Lines (Items U1-U39)					\$	595,624.00	\$	504,877.00	\$	491,913.78	\$	529,929.50	\$	495,818.50
TOTAL BASE BID (All Bid Items)					\$	5,574,726.35	\$	6,757,946.50	\$	5,937,809.61	\$	5,588,770.40	\$	5,738,602.60

CERTIFIED: 
 Andrea Rennie, CPPO, CPPO, Purchasing Manager

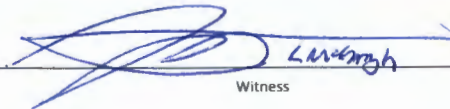
 Witness

11/30/2017
 Date

DOCUMENT 00400 –BID FORM

Contract Name: W. Starry Night View – W. Mount Comfort Rd. (N. Ruppel Rd.)

Bid Number 17-67

BID TO:

Owner: The City of Fayetteville, Arkansas
113 West Mountain Street
Fayetteville, Arkansas 72701

BID FROM:

Bidder:

Crossland Heavy Contractors, Inc.
PO Box 350
501 S. East Avenue
Columbus, KS 66725

ARTICLE 1 - INTENT

1.01 The undersigned Bidder proposes and agrees, if this Bid is accepted, to enter into an agreement with Owner in the form included in the Contract Documents to perform and furnish all Work as specified or indicated in the Contract Documents for the Bid price and within the Bid time indicated in this Bid and in accordance with the other terms and conditions of the Contract Documents.

ARTICLE 2 - TERMS AND CONDITIONS

2.01 Bidder accepts all of the terms and conditions of the Invitation to Bid and Instructions to Bidders, including without limitation those dealing with the disposition of Bid security. This Bid will remain subject to acceptance for 90 days after the day of Bid opening. Bidder will sign and deliver the required number of counterparts of the Agreement with the Bonds and other documents required by the Bidding Requirements within 15 days after the date of Owner's Notice of Award.

DOCUMENT 00400 –BID FORM (continued)

ARTICLE 3 - BIDDER'S REPRESENTATIONS

3.01 In submitting this Bid, Bidder represents, as more fully set forth in the Agreement, that:

A. Bidder has examined and carefully studied the Bid Documents, and the following Addenda, receipt of all which is hereby acknowledged:

<u>Number</u>	<u>Date</u>
<u>1</u>	<u>11-17-17</u>
<u>2</u>	<u>11-21-17</u>
<u>3</u>	<u>11-22-17</u>
<u> </u>	<u> </u>

B. Bidder has visited the Site and become familiar with and is satisfied as to the general, local, and Site conditions that may affect cost, progress, performance, and furnishing of the Work.

C. Bidder is familiar with and is satisfied as to all federal, state, and local Laws and Regulations that may affect cost, progress, performance, and furnishing of the Work.

D. Bidder has carefully studied all: (1) reports of explorations and tests of subsurface conditions at or contiguous to the Site and all drawings of physical conditions in or relating to existing surface or subsurface structures at or contiguous to the Site; and (2) reports and drawings of a Hazardous Environmental Condition, if any, at the Site. Bidder acknowledges that such reports and drawings are not Contract Documents and may not be complete for Bidder's purposes. Bidder acknowledges that Owner and Engineer do not assume responsibility for the accuracy or completeness of information and data shown or indicated in the Bid Documents with respect to Underground Facilities at or contiguous to the Site.

DOCUMENT 00400 –BID FORM (continued)

- E. Bidder has obtained and carefully studied (or assumes responsibility for having done so) all such additional or supplementary examinations, investigations, explorations, tests, studies, and data concerning conditions (surface, subsurface, and Underground Facilities) at or contiguous to the Site or otherwise which may affect cost, progress, performance, or furnishing of the Work or which relate to any aspect of the means, methods, techniques, sequences, and procedures of construction to be employed by Bidder and safety precautions and programs incident thereto.
- F. Bidder does not consider that any additional examinations, investigations, explorations, tests, studies, or data are necessary for the determination of this Bid for performing and furnishing of the Work in accordance with the times, price, and other terms and conditions of the Contract Documents.
- G. Bidder is aware of the general nature of work to be performed by Owner and others at the Site that relates to Work for which this Bid is submitted as indicated in the Contract Documents.
- H. Bidder has correlated the information known to Bidder, information and observations obtained from visits to the Site, reports, and drawings identified in the Contract Documents, and all additional examinations, investigations, explorations, tests, studies, and data with the Contract Documents.
- I. Bidder has given Engineer written notice of all conflicts, errors, ambiguities, or discrepancies that Bidder has discovered in the Contract Documents, and the written resolution thereof by Engineer is acceptable to Bidder.
- J. The Contract Documents are generally sufficient to indicate and convey understanding of all terms and conditions for performing and furnishing the Work for which this Bid is submitted.
- K. This Bid is genuine and not made in the interest of or on behalf of any undisclosed person, firm, or corporation and is not submitted in conformity with any agreement or rules of any group, association, organization, or corporation; Bidder has not directly or indirectly induced or solicited any

DOCUMENT 00400 –BID FORM (continued)

other Bidder to submit a false or sham bid; Bidder has not solicited or induced any person, firm, or a corporation to refrain from bidding; and Bidder has not sought by collusion to obtain for himself any advantage over any other Bidder or over Owner.

- L. Bidder will perform the Work in compliance with all applicable trench safety standards set forth in Occupational Safety and Health Administration (OSHA) Part 1926 – Subpart P – Excavations.

ARTICLE 4 - BID PRICE

Bidder will complete the Work in accordance with the Contract Documents for the following price(s):

ITEM NO.	CITY SPEC. NO.	DESCRIPTION	UNIT	ESTIMATED QUANTITY	UNIT PRICE	BID AMOUNT
1	111	Roadway Construction Control	LS	1	25,000.00	25,000.00
2	112	Trench and Excavation Safety Systems	LS	1	1,000.00	1,000.00
3	201	Clearing, Grubbing, and Demolition	LS	1	96,000.00	96,000.00
4	SP-14	Unclassified Excavation (Plan Quantity)	CY	11,824	9.00	106,416.00
5	SP-14	Embankment Construction (Plan Quantity)	CY	33,167	12.75	422,879.25
6	SP-14	Undercut Excavation	CY	2,000	10.50	21,000.00
7	SP-14	Rock Excavation	CY	500	90.00	45,000.00
8	203	Subgrade Preparation (Plan Quantity)	SY	10,238	2.75	28,154.50
9	204	4" Topsoil Placement (Yard Areas)	SY	29,205	4.25	124,121.25
10	205	Undercut and Stone Backfill	Ton	5,000	34.50	172,500.00
11	301	18" Class III R.C. Pipe	LF	295	63.00	18,585.00
12	301	24" Class III R.C. Pipe	LF	274	82.00	22,468.00
13	301	30" Class III R.C. Pipe	LF	831	74.00	61,494.00
14	301	36" Class III R.C. Pipe	LF	786	117.00	91,962.00

DOCUMENT 00400 – BID FORM (continued)

15	301	53"x34" Class III R.C. Elliptical Pipe	LF	229	140.00	32,060.00
16	301	18" R.C. Flared End Section	EA	8	500.00	4,000.00
17	301	24" R.C. Flared End Section	EA	5	650.00	3,250.00
18	301	53"x34" R.C. Elliptical Flared End Section	EA	1	1,500.00	1,500.00
19	302	4' Drop Inlet (Type MO)	EA	1	3,150.00	3,150.00
20	302	5' Drop Inlet (Type MO)	EA	5	4,300.00	21,500.00
21	302	6' Drop Inlet (Type MO)	EA	2	5,500.00	11,000.00
22	302	5' Junction Box (Type MO)	EA	3	4,900.00	14,700.00
23	302	4' Drop Inlet Extension	EA	8	1,200.00	9,600.00
24	302	8' Drop Inlet Extension	EA	8	2,000.00	16,000.00
25	302	12' Drop Inlet Extension	EA	1	2,600.00	2,600.00
26	305	Channel Excavation (Plan Quantity)	CY	1,270	11.50	14,605.00
27	305	Concrete Channel Paving	SY	440	39.00	17,160.00
28	305	Erosion Control Fabric	SY	3,500	33.75	118,125.00
29	401	4" Aggregate Base Course	SY	3,127	9.25	28,924.75
30	401	8" Aggregate Base Course	SY	10,238	8.50	87,023.00
31	403	Asphalt Concrete Hot Mix Binder Course (ACHMBC)	Ton	2,250	71.00	159,750.00
32	403	Asphalt Concrete Hot Mix Surface Course (ACHMSC)	Ton	1,200	89.00	106,800.00
33	405	Asphalt Concrete Hot Mix Patching for Maintenance of Traffic	Ton	100	200.00	20,000.00
34	501	Concrete Curb and Gutter	LF	5,687	12.50	71,087.50
35	502	4" Thick Concrete Sidewalk	SY	1,158	38.25	44,293.50
36	502	6" Thick Concrete Sidewalk	SY	10	44.00	440.00
37	503	Concrete Driveway Aprons	SY	77	46.00	3,542.00
38	503	Asphalt Driveway	SY	1,161	21.50	24,961.50
39	503	Aggregate Base Course Driveway	SY	183	15.00	2,745.00
40	505	Seeding and Mulching	Acre	11.0	3,200.00	35,200.00
41	505	Solid Sod	SY	5,900	5.50	32,450.00

DOCUMENT 00400 – BID FORM (continued)

42	505	Additional Watering	MG	700	5.50	3,850.00
43	506	Mailbox Supports (single)	EA	3	120.00	360.00
44	506	Mailboxes	EA	3	120.00	360.00
45	507	4" Pavement Marking (Thermoplastic)	LF	9,250	1.45	13,412.50
46	507	6" Pavement Marking (Thermoplastic)	LF	743	1.45	1,077.35
47	507	12" Pavement Marking (Thermoplastic)	LF	724	11.50	8,326.00
48	507	Pavement Symbols (Yield Line) (Thermoplastic)	SF	12	52.00	624.00
49	507	Pavement Symbols (Arrow) (Thermoplastic)	EA	15	466.00	6,990.00
50	507	Pavement Symbols (ONLY) (Thermoplastic)	EA	12	400.00	4,800.00
51	507	4" Pavement Marking (Reflectorized Paint)	LF	849	4.50	3,820.50
52	507	Pavement Marking Removal	SF	196	1.45	284.20
53	508	Street Sign Installation	EA	16	700.00	11,200.00
54	509	Erosion Control	LS	1	30,000.00	30,000.00
55	510	Traffic Control and Maintenance	LS	1	10,000.00	10,000.00
56	511	Mobilization (not to exceed 5% of contract price)	LS	1	77,500.00 102,500.00	77,500.00 102,500.00
57	512	Barbed Wire Fence	LF	2,119	7.25	15,362.75
58	512	Wood Privacy Fence	LF	200	27.00	5,400.00
59	512	Gates for Wood Privacy Fence	LF	20	42.00	840.00
60	512	Temporary Fencing	LF	2,119	7.25	15,362.75
61	513	Cast-in-Place Detectable Warning Panel	SF	118	18.00	2,124.00
62	513	Handicap Access Ramp	SY	87	34.00	2,958.00
63	514	Project Sign	EA	2	850.00	1,700.00
64	516	Cold Milling Asphalt Pavement	SY	1,600	8.00	12,800.00
65	517	Tree Protection Fencing	LF	400	2.00	800.00
66	SP-3	Trail Sign Installation	EA	1	1,900.00	1,900.00
67	SP-4	Concrete Island	SY	197	44.00	8,668.00
68	SP-5	4" Thick Concrete Trail	SY	2,614	39.00	101,946.00

DOCUMENT 00400 – BID FORM (continued)

69	SP-5	6" Thick Concrete Trail	SY	20	43.00	860.00
70	SP-6	Gravity Block Retaining Wall #1 (Plan Quantity)	SF	341	55.00	18,755.00
71	SP-6	Gravity Block Retaining Wall #2 (Plan Quantity)	SF	2,546	55.00	140,030.00
72	SP-6	Gravity Block Retaining Wall #3 (Plan Quantity)	SF	4,701	55.00	258,555.00
73	SP-6	Gravity Block Retaining Wall #4 (Plan Quantity)	SF	6,018	55.00	330,990.00
74	SP-7	Pipe Underdrain	LF	800	7.00	5,600.00
75	SP-9	5'x5' Special Deep Drop Inlet	EA	4	9,800.00	39,200.00
76	SP-9	7'x7' Special Deep Drop Inlet	EA	1	12,000.00	12,000.00
77	SP-9	4'x5' Reverse Throat Inlet	EA	3	4,000.00	12,000.00
78	SP-9	Modify Existing 5' Deep Drop Inlet	EA	1	2,500.00	2,500.00
79	SP-12	Decorative Fence	LF	1,600	65.00	104,000.00
80	SP-13	Decorative Gravel (6" Depth)	SY	356	14.00	4,984.00
81	SP-16	Bridge Construction Control	LS	1	22,000.00	22,000.00
82	SP-16	Unclassified Excavation for Structures - Bridge	CY	409	60.00	24,540.00
83	SP-16	Rock Excavation for Structures - Bridge	CY	97	160.00	15,520.00
84	SP-16	Class S Concrete - Bridge	CY	495	522.00	258,390.00
85	SP-16	Class S(AE) Concrete - Bridge	CY	410	588.00	241,080.00
86	SP-16	Class 2 Protective Surface Treatment	SY	1,717	4.50	7,726.50
87	SP-16	Reinforcing Steel - Bridge (Grade 60)	LB	55,570	.85	47,234.50
88	SP-16	Epoxy Coated Reinforcing Steel (Grade 60)	LB	120,670	.90	108,603.00
89	SP-16	Transitional Approach Railing	EA	4	3,500.00	14,000.00
90	SP-16	Structural Steel in Plate Girder Spans (M270-GR. 50W)	LB	373,280	1.88	701,766.40
91	SP-16	Elastomeric Bearings	CUIN	12,192	2.45	29,870.40
92	SP-16	Silicone Joint Sealant	LF	141	52.00	7,332.00
93	SP-16	Filter Blanket	SY	262	8.00	2,096.00
94	SP-16	Dumped Riprap	CY	272	58.00	15,776.00
95	SP-17	Steel Piling (HP12X53)	LF	165	73.50	12,045.00

DOCUMENT 00400 – BID FORM (continued)

96	SP-18	Metal Bridge Railing (Type H2)	LF	179	67.00	11,993.00
97	SP-19	Preboring	LF	110	252.00	27,500.00
98	SP-20	Textured Coating Finish	SY	393	8.25	3,242.25
99	305	<u>Concrete Channel Paving with Vertical Retaining Walls</u>	<u>SY</u>	<u>60</u>	140.00	8,400.00
U1	1000	Construction Staking for Water & Sewer	LS	1	7,750.00	7,750.00
U2	1000	Traffic Control and Maintenance for Water & Sewer	LS	1	1,500.00	1,500.00
U3	1000	Wastewater Bypass Pumping	LS	1	9,000.00	9,000.00
U4	1000	Bonds & Insurance	LS	1	8,000.00	8,000.00
U5	2000	Trench and Excavation Safety Systems for Water & Sewer	LS	1	3,500.00	3,500.00
U6	2100	Erosion Control for Water & Sewer	LS	1	7,500.00	7,500.00
U7	2100	Dewatering	LS	1	11,500.00	11,500.00
U8	2100	Mitigation Dam	EA	2	1,500.00 225.00	3,000.00 47,500.00
U9	2200	Clearing, Grubbing, and Demolition for Water & Sewer	LS	1	7,500.00 7,500.00	7,500.00 7,500.00
U10	2300	Undercut and Backfill for Water & Sewer	CY	50	31.00 170.00	1,550.00 1,550.00
U11	2300	Rock Excavation for Water & Sewer	CY	500	225.00 225.00	112,500.00
U12	2300	Flowable Fill for Abandoned Pipelines	LF	1,435	9.00	12,915.00
U13	2300	Backfill Density Test	EA	10	170.00	1,700.00
U14	3000	Sewer Service Line	LF	50	22.00	1,100.00
U15	3000	Connect Sewer Service	EA	1	325.00	325.00
U16	3000	10" PVC Sewer Line	LF	239	51.00	12,189.00
U17	3300	4' ID Manhole, 0' to 6' Depth	EA	3	2,250.00	6,750.00
U18	3300	4' ID Manhole Additional Depth, Over 6'	VF	6	220.00	1,320.00
U19	3300	Demolish Existing Manhole	EA	1	1,100.00	1,100.00
U20	S18	Reinforced Flexible Coupling	EA	1	180.00	180.00
U21	3300	Modify Sewer Invert	EA	1	500.00	500.00
U22	3400	24" Bored Steel Encasement for Water Line	LF	135	840.00	113,400.00

DOCUMENT 00400 – BID FORM (continued)

U23	4000	Fire Hydrant Assembly	EA	2	4,600.00	9,200.00
U24	4000	12" Ductile Iron Water Line (Class 350)	LF	1,840	98.00	180,320.00
U25	4000	8" Ductile Iron Water Line (Class 350)	LF	95	85.00	8,075.00
U26	4000	Ductile Iron Fittings	LB	1,865	11.00	20,515.00
U27	4000	12" x 12" Tapping Sleeve & Valve	EA	2	6,900.00	13,800.00
U28	4000	12" Gate Valve	EA	1	2,650.00	2,650.00
U29	4000	Water Meter Setting	EA	2	940.00	1,880.00
U30	4000	Water Service Line	LF	172	25.00	4,300.00
U31	4100	Cut & Cap Existing 6" AC Water Line	EA	4	1,400.00	5,600.00
U32	4100	Cut & Cap Existing 12" PVC Water Line	EA	1	1,800.00	1,800.00
U33	5200	Concrete Test	EA	2	150.00	300.00
U34	S11	Core Drill & Connect to Existing Manhole	EA	1	1,000.00	1,000.00
U35	S12	Adjust Existing Manhole to Finished Grade	EA	1	2,150.00	2,150.00
U36	S13	Abandon Existing Manhole	EA	1	900.00	900.00
U37	W20	2" Blowoff Assembly	EA	1	3,500.00	3,500.00
U38	4100	Adjust Existing Valve Box to Finished Grade	EA	2	500.00	1,000.00
U39	3400	24" Open Cut Steel Encasement for Water Line	LF	71	195.00	13,485.00

SUB TOTAL AMOUNT BID FOR ROADWAY*

\$ 4,979,102.35

*Total amount for items 1 to 99 listed above

SUB TOTAL AMOUNT BID FOR WATER
AND SANITARY SEWER LINES**

\$ 595,624.00

**Total amount for items U1 to U39 listed above

DOCUMENT 00400 –BID FORM (continued)

TOTAL AMOUNT BID***

\$ 5,574,726.35

***Total bid amount for all bid items listed above and total of subtotals
listed above

Award will be to a single contractor based on the total amount bid. Bidders shall submit a bid for all line items.

ARTICLE 5 - CONTRACT TIMES

- 5.01 Bidder agrees that the Work will be substantially completed and completed and ready for final payment within the number of calendar days indicated in the Agreement.
- 5.02 Bidder accepts the provisions of the Agreement as to liquidated damages in the event of failure to complete the Work within the times specified in the Agreement.

ARTICLE 6 - BID CONTENT

- 6.01 The following documents are attached to and made a condition of this Bid:
- A. Required Bid security in the form of a certified or bank cashier's check or a Bid Bond and in the amount of 5% of the
amount bid Dollars (\$ _____).
 - B. A tabulation of Subcontractors and other persons and organizations required to be identified in this Bid.

DOCUMENT 00400 - BID FORM (continued)

ARTICLE 7- COMMUNICATIONS

7.01 Communications concerning this Bid shall be addressed to the Bidder as follows:

Crossland Heavy Contractors, Lnc.

501 S. East Avenue

Columbus, KS 66725

Phone No. 620-429-1410

FAX No. 620-429-2977

DOCUMENT 00400 –BID FORM (continued)

ARTICLE 8 - TERMINOLOGY

8.01 The terms used in this Bid which are defined in the GENERAL CONDITIONS or Instructions to Bidders will have the meanings assigned to them.

SUBMITTED on Nov. 29th, 2017

If Bidder is:

An Individual

Name (type or printed): _____

By: _____ (SEAL)

(Individual's Signature)

Doing business as: _____

Business address: _____

Phone No.: _____ FAX No.: _____

DOCUMENT 00400 – BID FORM (continued)

A Partnership

Partnership Name: _____ (SEAL)

By: _____

(Signature of general partner – attach evidence of authority to sign)

Name (type or printed): _____

Business address: _____

Phone No.: _____ FAX No.: _____

DOCUMENT 00400 – BID FORM (continued)

A Corporation

Corporation Name: Crossland Heavy Contractors, Inc.

State of Incorporation: Kansas

Type (General Business, Professional, Service, Limited Liability): _____

General Business

By: [Signature]

(Signature – attach evidence of authority to sign)

Name (type or printed): Mark Sell

Title: President

(CORPORATE SEAL)

Attest: [Signature]

(Signature of Corporate Secretary)

Business address: 501 S. East Avenue

Columbus, KS 66725

Phone No.: 620-429-1410 FAX No.: 620-429-2977

END OF DOCUMENT 00400

DOCUMENT 00410 – BID BOND

KNOW ALL MEN BY THESE PRESENTS: that we

Crossland Heavy Contractors, Inc.
PO Box 350
Columbus, KS 66725

as Principal, hereinafter called the Principal, and

Fidelity and Deposit Company of Maryland
1299 Zurich Way, 5th Floor
Schaumburg, IL 60196 - 1056

a corporation duly organized under the laws of the State of Maryland as Surety, hereinafter called Surety, are held and firmly bound unto

City of Fayetteville, Arkansas
 113 West Mountain Street
 Fayetteville, Arkansas 72701

as Obligee, hereinafter called Owner, in the sum of **Five Percent of Amount Bid**
 _____ Dollars (\$ 5%), for the payment of which
 sum, well and truly to be made, Principal and said Surety, bind ourselves, our heirs, executors,
 administrators, successors and assigns, jointly and severally, firmly by these presents.

WHEREAS, Principal has submitted a Bid for W. STARRY NIGHT VIEW – W. MT.
 COMFORT RD. (N. RUPPLE RD.)

NOW, THEREFORE, if the Owner shall accept the Bid of Principal and the Principal shall enter into a Contract with the Owner in accordance with the terms of such Bid, and give such Bond or Bonds as may be specified in the Bidding or Contract Documents with good and sufficient surety for the faithful performance of such Contract and for the prompt payment of labor and material furnished in the prosecution thereof, or in the event of the failure of Principal to enter such Contract and give such Bond or Bonds, if the Principal shall pay to the Owner the difference not to exceed the penalty hereof between the amount specified in said Bid and such larger amount for

DOCUMENT 00410 – BID BOND (continued)

which the Owner may in good faith contract with another party to perform the Work covered by said Bid, then this obligation shall be null and void, otherwise to remain in full force and effect.

Signed and sealed this 29th day of November 2017 .

PRINCIPAL

(CORPORATE SEAL)

Crossland Heavy Contractors, Inc.

By

Mark Sell, President

SURETY

Fidelity and Deposit Company of Maryland

By

Larissa Smith, Attorney-in-Fact

ATTORNEY-IN-FACT

(CORPORATE SEAL)

1299 Zurich Way, 5th Floor

Schaumburg, IL 60196 - 1056

(This Bond shall be accompanied with
Attorney-in-Fact's authority from Surety)

END OF DOCUMENT 00410

**ZURICH AMERICAN INSURANCE COMPANY
COLONIAL AMERICAN CASUALTY AND SURETY COMPANY
FIDELITY AND DEPOSIT COMPANY OF MARYLAND
POWER OF ATTORNEY**

KNOW ALL MEN BY THESE PRESENTS: That the ZURICH AMERICAN INSURANCE COMPANY, a corporation of the State of New York, the COLONIAL AMERICAN CASUALTY AND SURETY COMPANY, a corporation of the State of Maryland, and the FIDELITY AND DEPOSIT COMPANY OF MARYLAND a corporation of the State of Maryland (herein collectively called the "Companies"), by **DAVID MCVICKER, Vice President**, in pursuance of authority granted by Article V, Section 8, of the By-Laws of said Companies, which are set forth on the reverse side hereof and are hereby certified to be in full force and effect on the date hereof, do hereby nominate, constitute, and appoint **S. Mark WILKERSON, Morgan DEWEY, Monica F. DONATELLI, Debra L. WALZ, Carolyn J. JOHNSON, Larissa SMITH and Kelly E. KIMMEL, all of Overland Park, Kansas, EACH** its true and lawful agent and Attorney-in-Fact, to make, execute, seal and deliver, for, and on its behalf as surety, and as its act and deed: **any and all bonds and undertakings**, and the execution of such bonds or undertakings in pursuance of these presents, shall be as binding upon said Companies, as fully and amply, to all intents and purposes, as if they had been duly executed and acknowledged by the regularly elected officers of the ZURICH AMERICAN INSURANCE COMPANY at its office in New York, New York., the regularly elected officers of the COLONIAL AMERICAN CASUALTY AND SURETY COMPANY at its office in Owings Mills, Maryland., and the regularly elected officers of the FIDELITY AND DEPOSIT COMPANY OF MARYLAND at its office in Owings Mills, Maryland., in their own proper persons.

The said Vice President does hereby certify that the extract set forth on the reverse side hereof is a true copy of Article V, Section 8, of the By-Laws of said Companies, and is now in force.

IN WITNESS WHEREOF, the said Vice-President has hereunto subscribed his/her names and affixed the Corporate Seals of the said **ZURICH AMERICAN INSURANCE COMPANY, COLONIAL AMERICAN CASUALTY AND SURETY COMPANY, and FIDELITY AND DEPOSIT COMPANY OF MARYLAND**, this 29th day of September, A.D. 2017.

ATTEST:

**ZURICH AMERICAN INSURANCE COMPANY
COLONIAL AMERICAN CASUALTY AND SURETY COMPANY
FIDELITY AND DEPOSIT COMPANY OF MARYLAND**



By: *Dawn E. Brown*
Assistant Secretary
Dawn E. Brown

David McVicker
Vice President
David McVicker

State of Maryland
County of Baltimore

On this 29th day of September, A.D. 2017, before the subscriber, a Notary Public of the State of Maryland, duly commissioned and qualified, **DAVID MCVICKER, Vice President, and DAWN E. BROWN, Assistant Secretary**, of the Companies, to me personally known to be the individuals and officers described in and who executed the preceding instrument, and acknowledged the execution of same, and being by me duly sworn, depose and saith, that he/she is the said officer of the Company aforesaid, and that the seals affixed to the preceding instrument are the Corporate Seals of said Companies, and that the said Corporate Seals and the signature as such officer were duly affixed and subscribed to the said instrument by the authority and direction of the said Corporations.

IN TESTIMONY WHEREOF, I have hereunto set my hand and affixed my Official Seal the day and year first above written.

Constance A. Dunn



Constance A. Dunn, Notary Public
My Commission Expires: July 9, 2019

EXTRACT FROM BY-LAWS OF THE COMPANIES

"Article V, Section 8, Attorneys-in-Fact. The Chief Executive Officer, the President, or any Executive Vice President or Vice President may, by written instrument under the attested corporate seal, appoint attorneys-in-fact with authority to execute bonds, policies, recognizances, stipulations, undertakings, or other like instruments on behalf of the Company, and may authorize any officer or any such attorney-in-fact to affix the corporate seal thereto; and may with or without cause modify or revoke any such appointment or authority at any time."

CERTIFICATE

I, the undersigned, Vice President of the ZURICH AMERICAN INSURANCE COMPANY, the COLONIAL AMERICAN CASUALTY AND SURETY COMPANY, and the FIDELITY AND DEPOSIT COMPANY OF MARYLAND, do hereby certify that the foregoing Power of Attorney is still in full force and effect on the date of this certificate; and I do further certify that Article V, Section 8, of the By-Laws of the Companies is still in force.

This Power of Attorney and Certificate may be signed by facsimile under and by authority of the following resolution of the Board of Directors of the ZURICH AMERICAN INSURANCE COMPANY at a meeting duly called and held on the 15th day of December 1998.

RESOLVED: "That the signature of the President or a Vice President and the attesting signature of a Secretary or an Assistant Secretary and the Seal of the Company may be affixed by facsimile on any Power of Attorney...Any such Power or any certificate thereof bearing such facsimile signature and seal shall be valid and binding on the Company."

This Power of Attorney and Certificate may be signed by facsimile under and by authority of the following resolution of the Board of Directors of the COLONIAL AMERICAN CASUALTY AND SURETY COMPANY at a meeting duly called and held on the 5th day of May, 1994, and the following resolution of the Board of Directors of the FIDELITY AND DEPOSIT COMPANY OF MARYLAND at a meeting duly called and held on the 10th day of May, 1990.

RESOLVED: "That the facsimile or mechanically reproduced seal of the company and facsimile or mechanically reproduced signature of any Vice-President, Secretary, or Assistant Secretary of the Company, whether made heretofore or hereafter, wherever appearing upon a certified copy of any power of attorney issued by the Company, shall be valid and binding upon the Company with the same force and effect as though manually affixed.

IN TESTIMONY WHEREOF, I have hereunto subscribed my name and affixed the corporate seals of the said Companies, this 29th day of November, 2017.



Michael Bond, Vice President

TO REPORT A CLAIM WITH REGARD TO A SURETY BOND, PLEASE SUBMIT ALL REQUIRED INFORMATION TO:

Zurich American Insurance Co.
Attn: Surety Claims
1299 Zurich Way
Schaumburg, IL 60196-1056

DOCUMENT 00430 – LIST OF SUBCONTRACTORS

In compliance with the Instructions to Bidders and other Contract Documents, the undersigned submits the following names of Subcontractors to be used in performing the Work for W. STARRY NIGHT VIEW – W. MOUNT COMFORT RD. (N. RUPPLE RD.)

Bidder certifies that all Subcontractors listed are eligible to perform the Work.

<u>Subcontractor's Work</u>	<u>Subcontractor's Name and Address</u>	<u>Expected Percentage or Value</u>
<u>BASE + ASPHALT</u>	<u>APAC</u> <u>755 MUSAP RD. FAYETTEVILLE, AR 72703</u>	<u>6.5%</u>
<u>EROSION CONTROL</u>	<u>JLA CONSTRUCTION</u> <u>P.O. BOX 718, BROOKLINE, MO</u>	<u>3.6%</u>
<u>FENCE</u>	<u>CENTERPOINT CONTRACTORS</u> <u>10314 EAST HIGHWAY 72, BENTONVILLE, AR</u>	<u>2.6%</u>
<u>STRIPING</u>	<u>TIME STRIPING</u> <u>P.O. BOX 1236 VAN BUREN</u>	<u>0.9%</u>
<u>WALLS</u>	<u>WESTROCK WALLS</u> <u>42 MADISON TRAIL PERRY, AR</u>	<u>12.2%</u>
_____	_____	_____
_____	_____	_____
_____	_____	_____
_____	_____	_____
_____	_____	_____
_____	_____	_____
_____	_____	_____

NOTE: This form must be submitted in accordance with the Instructions to Bidders.

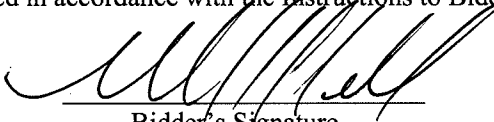
 Bidder's Signature
 Mark Sell

END OF DOCUMENT 00430

DOCUMENT 00440 – LIST OF MANUFACTURERS

In compliance with the Instructions to Bidders and other Contract Documents, the undersigned submits the following names of Manufacturers to be used in performing the Work for W. STARRY NIGHT VIEW – W. MOUNT COMFORT RD. (N. RUPPLE RD.)

Bidder certifies that all Manufacturers listed are eligible to perform the Work.

Manufacturer's Work

Manufacturers's Name
and Address

Retaining Walls

PEDI-ROCK c/o INDUSTRIAL PRECAST
7201 SOUTH 28TH FT. SMITH, AR

Other (designate)

Other (designate)

NOTE: This form must be submitted in accordance with the Instructions to Bidders.

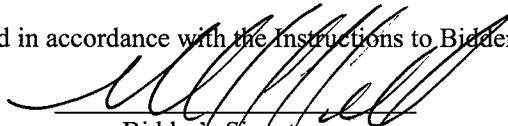
Bidder's Signature
Mark Sell

END OF DOCUMENT 00440

CROSSLAND HEAVY CONTRACTORS

501 S. East Avenue
P.O. Box 350
Columbus, KS 66725
tel 620.429.1410
fax 620.429.2977

Corporate Resolution

BE IT RESOLVED: that at the monthly meeting of the Board of Directors of Crossland Heavy Contractors, Inc., held on the 2nd day of December, 2016, the Board of Directors did, by unanimous decision, authorize Mark Sell, Chris Walters, Justin Lillie, Dan Thompson or Ivan Crossland, Jr. to sign on behalf of said Corporation all documents and papers pertaining to the business of said Corporation.

All documents signed by Mark Sell, Chris Walters, Justin Lillie, Dan Thompson or Ivan Crossland, Jr. on behalf of Crossland Heavy Contractors, Inc. shall be legally binding on Crossland Heavy Contractors, Inc. and their successors and assigns.

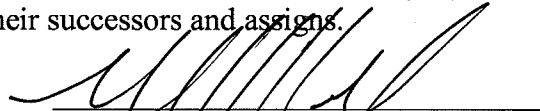

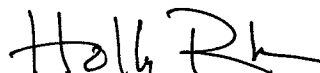
Mark Sell, President

ATTEST: 
Holly Rhodes, Secretary

State of Kansas, County of Cherokee:

Before me, the undersigned Notary Public in and for the County and State aforesaid, personally appeared Mark Sell, President of Crossland Heavy Contractors, Inc. a corporation duly organized and existing in the State of Kansas, and he acknowledged the same on behalf of said Corporation.

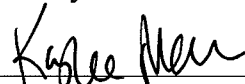
In witness thereof I have set my hand and affixed my seal this 23rd day of January 2017.

Notary Public

My Commission Expires: 6/29/19

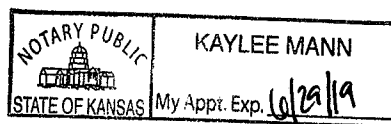

CITY OF FAYETTEVILLE
SUPPLEMENT TO PROPOSAL
ANTI-COLLUSION AND DEBARMENT CERTIFICATION

**FAILURE TO EXECUTE AND SUBMIT THIS CERTIFICATION SHALL RENDER THIS BID
NONRESPONSIVE AND NOT ELIGIBLE FOR AWARD CONSIDERATION.**

As a condition precedent to the acceptance of the bidding document for this project, the bidder shall file this Affidavit executed by, or on behalf of the person, firm, association, or corporation submitting the bid. The original of this Affidavit shall be filed with the City of Fayetteville **at the time proposals are submitted.**

AFFIDAVIT

I hereby certify, under penalty of perjury under the laws of the United States and/or the State of Arkansas, that the bidder listed below has not, either directly or indirectly, entered into any agreement, participated in any collusion, or otherwise taken any action in restraint of free competitive bidding in connection with the submitted bid for this project, is not presently barred from bidding in any other jurisdiction as a result of any collusion or any other action in restraint of free competition, and that the foregoing is true and correct.

Further, that except as noted below, the bidder, or any person associated therewith in the capacity of owner, partner, director, officer, principal investigator, project director, manager, auditor, or any position involving the administration of Federal funds:

- a. is not currently under suspension, debarment, voluntary exclusion, or determination of ineligibility by any Federal agency;
- b. has not been suspended, debarred, voluntarily excluded or determined ineligible by any Federal agency within the past 3 years;
- c. does not have a proposed debarment pending; and
- d. has not been indicted, convicted, or had an adverse civil judgment rendered by a court of competent jurisdiction in any matter involving fraud or official misconduct within the past 3 years.

CITY OF FAYETTEVILLE
SUPPLEMENT TO PROPOSAL
ANTI-COLLUSION AND DEBARMENT CERTIFICATION

**FAILURE TO EXECUTE AND SUBMIT THIS CERTIFICATION SHALL RENDER THIS BID
NONRESPONSIVE AND NOT ELIGIBLE FOR AWARD CONSIDERATION.**

EXCEPTIONS:

APPLIED TO	INITIATING AGENCY	DATES OF ACTION

Exceptions will not necessarily result in denial of award, but will be considered in determining bidder responsibility. Providing false information may result in criminal prosecution or administrative sanctions.

Job No. _____ Crossland Heavy Contractors, Inc.
(Name of Bidder)

F.A.P. No. _____
11-29-17
(Date Executed)

_____ [Signature]
(Signature)
President
(Title of Person Signing)

The following Notary Public certification is **OPTIONAL** and may or may not be completed at the contractor's discretion.

State of _____)
County of _____)ss.

_____, being duly sworn, deposes and says that he is

(Title) of _____
(Name of Bidder)

and that the above statements are true and correct.

Subscribed and Sworn to before me this _____ day of _____, 20____.
My commission expires: _____

(Notary Public)

(NOTARY SEAL)

CITY OF FAYETTEVILLE
SUPPLEMENT TO PROPOSAL
C E R T I F I C A T I O N

The prospective contractor certifies, by signing and submitting this proposal, to the best of his or her knowledge and belief, that:

- 1 No Federal appropriated funds have been paid or will be paid, by or on his or her behalf, to any person for influencing or attempting to influence an officer or employee of any Federal agency, a Member of Congress, an officer or employee of Congress, or any employee of a Member of Congress in connection with the awarding of any Federal contract, the making of any Federal grant, the making of any Federal loan, the entering into of any cooperative agreement, and the extension, continuation, renewal, amendment, or modification of any Federal contract, grant, loan, or cooperative agreement.
- 2 If any funds other than Federal appropriated funds have been paid or will be paid to any person for influencing or attempting to influence an officer or employee of any Federal agency, a Member of Congress, an officer or employee of Congress, or an employee of a Member of Congress in connection with this Federal-Aid contract, the prospective contractor shall complete and submit Standard Form-LLL, "Disclosure of Lobbying Activities", in accordance with its instructions. (Available from Arkansas Department of Transportation, Program Management Division).

This Certification is a material representation of fact upon which reliance was placed when this transaction was made or entered into. This Certification is a prerequisite for making or entering into this transaction imposed by Section 1352, Title 31, U. S. Code.

During the period of performance of this contract, the contractor and all lower tier subcontractors must file a Form-LLL at the end of each calendar year quarter in which there occurs any event that requires disclosure or that materially affects the accuracy of the information contained in any previously filed disclosure form. Any person who fails to file the required Certification shall be subject to a civil penalty of not less than \$10,000 and not more than \$100,000 for each failure.

The prospective contractor also agrees by submitting his or her proposal that he or she shall require that the language of this Certification be included in all lower tier subcontracts which exceed \$100,000 and that all such subcontractors shall certify and disclose accordingly.

**CITY OF FAYETTEVILLE
SUPPLEMENT TO PROPOSAL
C E R T I F I C A T I O N**

**THIS CERTIFICATION SHALL BE COMPLETED BY THE BIDDER AS
PART OF THIS PROPOSAL**

The bidder Crossland Heavy Contractors, Inc. proposed subcontractor _____, hereby certifies that he has X, has not _____, participated in a previous contract or subcontract subject to the equal opportunity clause, as required by Executive Orders 10925, 11114, or 11246, and that he has X, has not _____, filed with the Joint Reporting Committee, the Director of the Office of Federal Contract Compliance, a Federal Government contracting or administering agency, or the former President's Committee on Equal Employment Opportunity, all reports due under the applicable filing requirements.

(Currently, Standard Form 100 [EEO-1] is the only report required by the Executive Orders or their implementing regulations.)

JOB NO. _____	<u>Crossland Heavy Contractors, Inc</u> (Company)
F.A.P. NO. _____	By: <u>[Signature]</u> (Signature) <u>Mark Sell</u>
<u>11-29-17</u> (Date Executed)	<u>President</u> (Title of Person Signing)

NOTE: The above certification is required by the Equal Employment Opportunity Regulations of the Secretary of Labor (41 CFR 60-1.7 (b) (1)), and must be submitted by bidders and proposed subcontractors only in connection with contracts and subcontracts which are subject to the equal opportunity clause. Contracts and subcontracts which are exempt from the equal opportunity clause are set forth in 41 CFR 60-1.5. (Generally only contracts or subcontracts of \$10,000 or under are exempt.)

Proposed prime contractors and subcontractors who have participated in a previous contract or subcontract subject to the Executive Orders and have not filed the required reports should note that 41 CFR 60-1.7 (b) (1) prevents the award of contracts and subcontracts unless such contractor submits a report covering the delinquent period or such other period specified by the Federal Highway Administration or by the Director, Office of Federal Contract Compliance, U. S. Department of Labor.

CITY OF FAYETTEVILLE

CERTIFICATION TO SUBMIT DBE PARTICIPATION

JOB 040657

If the bidder is not submitting the required DBE participation information or documentation of good faith efforts with the proposal, this form must be completed and submitted with the proposal.

The undersigned bidder irrevocably certifies that at least 10.0% of the total contract will be performed by certified Disadvantaged Business Enterprise (DBE) firms and the required DBE participation information will be submitted within 5 calendar days of notification of tentative award of the contract.

If DBE participation sufficient to achieve the DBE goal established for this project is not provided within 5 calendar days, the proposal will be rejected and the proposal guaranty shall become the property of the Commission, not as a penalty, but as liquidation of damages to the Department's DBE program.

Only work, materials, or services that will actually be provided by DBE firms will be credited toward the goal. The DBE firm's certification must be fully in effect at the letting date.

Crossland Heavy Contractors Inc.

Bidder

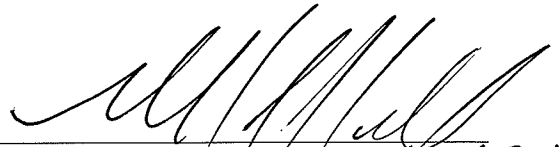

Signature (Owner/Agent) Mark Sell

11-29-17

Date

President

Title

EQUAL EMPLOYMENT OPPORTUNITY POLICY

It has been and shall continue to be the policy of Crossland Heavy Contractors, Inc., not to discriminate against any employee or applicant for employment because of that individual's race, sex, color, age, religion, national origin, or because he or she has a disability, is a special disabled veteran, or a Vietnam era veteran. All personnel actions, including recruiting, selection, hiring, placement, compensation, formal and informal training, transfers, promotions, layoffs, recalls and terminations, without regard to their race, religion, sex color, national origin, age or disability. Additionally, all salaries, wages, or other forms of compensation, benefit programs, social and recreational activities will be administered in conformity with this policy.

To further the company's commitment to equal employment opportunity, an Affirmative Action Program has been implemented to advance employment opportunities for minorities, women, disabled individuals, and disabled and Vietnam era veterans. This program does not favor one group over another, but seeks to provide an equal chance for all persons to be evaluated on the basis of their qualifications and abilities. The program also affirms the company's commitment to provide a work environment free from hostility and discrimination, including sexual harassment.

The AAP Officer is responsible for administering the corporate Affirmative Action Program and will report directly to me at regular intervals on the results of the program. The AAP Officer is also responsible for investigating employee complaints alleging discrimination at all locations. Employees and applicants are protected from coercion, intimidation interference or discrimination for filing complaints or assisting in an investigation.

If you are disabled or a disabled veteran and would like to know how you can benefit under the Affirmative Action Program, please tell us. You are not obligated in any way to identify your disability, and information you provide will be kept confidential unless your supervisor or first-aid personnel would need to know for safety or accommodation purposes.

Employees may review the Affirmative Action Program by contacting the Human Resources Department during regular working hours. Any communication from an applicant for employment, an employee, a government agency, or an attorney concerning any equal employment opportunity matter shall be referred immediately to the Human Resource Dept.

I am personally committed to this policy, and hereby assign all management employees the responsibility to support the policy through their actions and decisions. Additionally, an essential part of the company's Affirmative Action Program requires that all employees work together to develop an environment that fosters mutual employee respect free of discrimination, harassment and intimidation. Your support and cooperation is essential for our success.

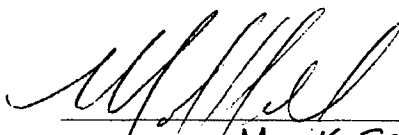

Mark Sell
President

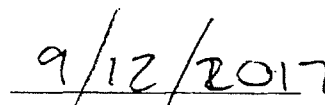

Date

Bid 17-67, Addendum 1

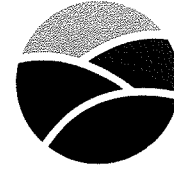

CITY OF
FAYETTEVILLE
ARKANSAS

Date: Friday November 17, 2017

To: All Prospective Vendors

From: Les McGaugh – 479.575.8220 – lmcgaugh@fayetteville-ar.gov

RE: Bid 17-67, Construction – Starry Night View to Mt. Comfort (Ripple Rd)

This addendum is hereby made a part of the contract documents to the same extent as though it were originally included therein. Bidders should indicate their receipt of same in the appropriate blank of the Bid Form. **BIDDERS SHOULD ACKNOWLEDGE THIS ADDENDUM ON THE DESIGNATED LOCATION ON THE BID FORM.**

1. The City held a non-mandatory pre-bid meeting held at the City on Wednesday October 04, 2017. Attached is the sign-in sheet for those who attended along with the agenda that was distributed. The answers to contractor questions can be found on the last page of the agenda.



CITY OF
FAYETTEVILLE
ARKANSAS

City of Fayetteville, Arkansas
Attendance Sheet

BID/RFP/RFQ #: 17-07

Description: Construction - Ruppel Rd (STREET LIGHT to Mt. Comfort)

Function (circle one): Bid Opening, Selection Committee Meeting, Pre-Bid Interview

Date: 11 / 14 / 2017 Time: 10:00 AM

City staff e-mail includes "@fayetteville-ar.gov"

	Name	Company	Title	Phone	Email
1	Les McCaugh	City of Fayetteville	Purch Agent	479-576-5220	lmcgaugh@_____
2	Jay Tenwell	APAC	ESTIMATOR	479-587-3300	jay.tenwell@apac.com
3	Vic Braddy	FORSGREEN INC	VP	479-782-1061	vbraddy@forsgreeninc.com
4	Kevin Kelton	FORSGREEN INC	VP	479-782-1061	kkelton@forsgreeninc.com
5	Martin Garcia	Mobley Contractors	Estimator	501-215-9990	mgarcia@mobleycontractors.com
6	Robert Chaney	APAC	PM	479-301-8163	robert.chaney@apac.com
7	Keith Roberts	RCR	PM	479-502-1515	kkeithrob@gmail.com
8	Charlie Miller	Sweetser	Estimator	479-263-9909	charlie@sweetserconstruction.com
9	Marty Starys	Manhattan Road & Bridge	PM	479-263-1810	Marty.Starys@manhattanrb.com
10	Mark Blake	Industrial Precast	GM	479-420-1676	mark.blake@cop.net
11	Tim Fernandes	Ferguson	SALES	479-435-0102	Tim.Fernandes@ferguson.com
12	Chris Brown	City of Fay	City Engineer	479-575-8207	cbrown@_____
13	Ron Petric	GARVER	SR. PM	479-527-9100	rspetric@garverusa.com
14	PAUL LIBERTINI	CITY	ENG	479-444-3419	PLIBERTINI@_____
15	Jeff Kless	GARVER	PM	479-527-9100	DKless@GARVERUSA.COM
16					
17					
18					
19					
20					

o Agenda Provided (4 Pages)



CITY OF
FAYETTEVILLE
ARKANSAS

PRE-BID MEETING MINUTES

Tuesday, November 14, 2017 – 10:00 a.m.

Bid 17-67, Construction
W. Starry Night View – W. Mount Comfort Rd. (N. Ruppel Rd.)
ARDOT Job No. 040657
F.A.P. No. STPU-9142(36)

(Additions in Red Text)

1. **General Introduction:** This project consists of approximately 1,800 L.F. of roadway construction with raised median, 182 L.F. of a new bridge, construction of associated earthwork and channelization, curb and gutter, sidewalk, shared use paths (trails), enclosed drainage, retaining walls, fencing, obliterating existing Ruppel Road, driveways, 12 inch waterline and appurtenance, 10 inch sanitary sewer, sanitary sewer manholes, and miscellaneous items.

- a) All bids shall be submitted in a sealed envelope or package labeled Bid 17-67. All bids shall be received by **Wednesday, November 29, 2017 before 2:00 PM**, local time at the City of Fayetteville, Purchasing Division address listed below. All bids will be opened and read aloud immediately following the deadline. No late bids shall be accepted. The City of Fayetteville shall not be responsible for lost or misdirected bids.

City of Fayetteville
Purchasing Division, Room 306, City Hall
113 West Mountain Street
Fayetteville, AR 72701

- b) Questions should be addressed to Les McGaugh, Purchasing Agent at lmcgaugh@fayetteville-ar.gov or by calling (479) 575-8220. Request for bid interpretations must be submitted by **2:00 p.m., Tuesday, November 20, 2017**.
- c) Garver will be providing part-time construction observation for this project.

2. **Contract Time**

- a) Contract Time is 300 consecutive calendar days. Calendar day contract time includes delays for all holidays, weekends including Saturday and Sunday, and normal weather-related events, such as rain, snow, and freezing temperatures that may affect the progress of the construction on a per-month basis. Reference is made to table on page ST-45 of the City Standard Specifications for Street and Drainage Construction for number of normal weather-related events per month.
- b) Owner and Contractor recognize that time is of the essence of this Agreement and that The City of Fayetteville will suffer financial loss if the Work is not completed within the time specified above, plus any extensions thereof allowed in accordance with the GENERAL CONDITIONS. The parties also recognize the delays, expense, and difficulties involved in proving the actual loss suffered by The City of Fayetteville if the Work is not Substantially Completed on time. Accordingly, the City of Fayetteville and Contractor agree that as liquidated damages for delay (but not as a penalty) Contractor shall pay The City of Fayetteville **Seven Hundred Fifty Dollars (\$750.00)** for each calendar day that expires after the time specified above in Paragraph 3.02 for Substantial Completion until the remainder of the Work is Substantially Complete. After Substantial Completion, if Contractor shall neglect, refuse, or fail to complete the remaining Work within 30 days for completion and readiness for final payment or any proper extension thereof granted by The City of Fayetteville, Contractor shall pay The City of Fayetteville **Seven Hundred Fifty Dollars**

(\$750.00) for each calendar day that expires after the time specified for completion and readiness for final payment.

3. Special Contract Requirements

- a) Buy America Provisions apply to this project.
- b) This project is a Federal-Aid Project. All applicable paperwork included in Contract documents must be submitted with bid. See Checklist.
- c) Prevailing Wage Rates apply.
- d) Certified Payrolls will be required to be submitted with your monthly pay invoices to Garver (including all Certified Payrolls from subs.) Your monthly pay invoices will not be processed until all required paperwork has been received and certified. If GC or Sub is not working on-site for a period of time, we required a "NO WORK THIS PERIOD" certified payroll.
- e) DBE percentage for this project = 10.0%

4. Normal Working Days And Times/ Holidays:

- a) Saturdays and holidays which may be declared in writing by the Owner for certain special or unusual circumstances will be optional to the Contractor as working days. Sunday work shall not be permitted.

5. Utility Relocations:

Approximate Utility Locations

Utility Owner	Facility Type	Location	Station Number	Est. Comp. Date
Ozark Electric	Overhead Electric	Power pole w/in prop. r/w	18+25 Lt.	12/31/2017
AT&T	Undgrmd Fiber & Copper	Parallel left Ruppel Rd	11+80 to 18+60	12/31/2017
City of Fayetteville Water/Sewer	12" Water Main	Parallel Right Ruppel Rd	12+20 Rt to 15+60 Rt	Part of construction contract
	6" Water Main	Parallel Right Ruppel Rd	15+60 Rt to 19+60 Lt	
	10" Sewer Main	Parallel Left Ruppel Rd	15+60 Lt to 18+40 Lt	
Black Hills (gas)	Undgrmd gas line	Parallel left then crossing	15+70 Rt to 19+00 Lt	12/31/2017
Cox Communications	Overhead cable	At power pole	18+25 Lt.	1/31/2018

AT&T will also be relocating a fiber optic line along the new alignment of Ruppel Road in a new 4" conduit. AT&T and the Contractor will have to work together to establish a timeline for this work to be completed since there is bridge, retaining walls, and a waterline going in across the creek.

6. Water and Sanitary Sewer Relocations

- a) Discuss 12" waterline boring under creek and location near proposed retaining walls.
- b) Modifications to Standard Specifications – Supplementary Conditions 00800 – Article 3.

3.01 SUPERSESSON

A. This Article supersedes the following sections of the 2012 Edition of the City of Fayetteville's Standard Specifications for Design and Construction of Water Lines and Sewer Lines:

1. Section 2300, Paragraph 2.03.A:
 - a. Change the paragraph to read as follows:
 - A. Grit material shall not be used. ASTM #67 aggregate shall be used for bedding water lines.
2. Section 2300, Paragraph 3.08.B:
 - a. Remove "or grit embedment materials".
3. Section 3600, Paragraph 2.01.F:
 - a. Revise the first sentence to read as follows: "Fly ash may be used as a partial cement replacement not exceeding 20% by weight of the cement when approved by the City."
4. Section 4100, Paragraph 3.20:
 - a. Add the following paragraph:
 - C. Verify and restrain any existing joints or valves between new connections and cut and cap locations with reinforced anchor collar prior to cutting and capping.

7. Ongoing Environmental Work N. Side of Hamestring Creek

- a) Scheduled to last through end of the year.

8. Maintenance of Traffic/ Sequence Of Construction

- a) The Contractor shall first erect temporary fence to control livestock and limit access of construction equipment and personnel onto private property. This includes maintaining a temporary fence across the creek.
- b) Any area outside the proposed ROW north of Hamestring Creek is off limits to any potential use as staging area due to environmental sensitivity.
- c) The Contractor is responsible for procuring a suitable location for a staging area.
- d) The Notice to Proceed for this project is anticipated to be in January or February 2018.

9. Construction Staking:

- a) Contractor's responsibility per Specification "Roadway Construction Control".

10. Materials Testing: City will provide materials testing firm.

11. Permits: SWPPP, STAA, COE Nationwide 404 Permit

12. Insurance Requirements:

- a) Commercial General and Umbrella Liability Insurance
- b) Owner's and Contractor's Protective Liability Insurance
- c) Commercial Auto and Umbrella Liability Insurance
- d) Workers' Compensation Insurance

13. Bridge

14. Retaining Walls

- a) Design calculations and detailed drawings stamped by Arkansas PE shall be submitted to the engineer for retaining walls.
- b) Contractor has the option to construct gravity retaining wall or MSE retaining wall per the details and locations shown in the Plans.
- c) Acid Stain for Retaining Wall. The color and strength of the acid stain will be determined during construction. Contractor shall provide up to three (3) tests areas to assist the City and the property owner in the determination of the final color and strength.

15. Water and Sewer Relocations

- a) Plans submitted November 9, 2017 for approval to ADH.

16. Addendums.

- a) None at this time.
- b) Minutes of this meeting will be available to planholders.

17. Contractor Questions:

- a) Question on width of thermoplastic striping. We will accept 4" striping as shown in the bid form, but an alternative of 6" will be acceptable.
- b) What areas are included in the 4" Topsoil Placement (Yard Areas) quantity? This quantity includes all areas receiving solid sod or seeding. This quantity also includes the area for existing Ruppel Road that is to be removed.
- c) Is the Sidewalk / Trail on the Bridge included in the Bridge Pay Items? Yes.
- d) Where is the pay item 4" Aggregate Base Course used? This pay item is for under the Concrete Trail.
- e) On asphalt driveways where is the 6" aggregate base course paid for? The 6" aggregate base course below asphalt driveways is included in the SY price bid for asphalt driveway.
- f) Prime Coat is not required for this project.
- g) Is the quantity for stripping (earthwork) included in the quantity (CY) in the Bid Form for Unclassified Excavation? The plan quantity for Unclassified Excavation includes stripping.
- h) Is a Material Transfer Device required for construction of asphalt courses? A Material Transfer Device is optional.
- i) Will a Redi-Rock retaining wall with ledgestone appearance be acceptable as an alternative to a Recon retaining wall with a weathered edge? Yes, as long as it meets the material specifications in the Project Manual.

Bid 17-67, Addendum 2



CITY OF
FAYETTEVILLE
ARKANSAS

Date: Tuesday, November 21, 2017

To: All Prospective Vendors

From: Les McGaugh – 479.575.8220 – lmcgaugh@fayetteville-ar.gov

RE: Bid 17-67, Construction – Starry Night View to Mt. Comfort (Ripple Rd)

This addendum is hereby made a part of the contract documents to the same extent as though it were originally included therein. Bidders should indicate their receipt of same in the appropriate blank of the Bid Form. **BIDDERS SHOULD ACKNOWLEDGE THIS ADDENDUM ON THE DESIGNATED LOCATION ON THE BID FORM.**

1. This Addendum includes a revised bid form which shall be used by all bidders. Failure to submit the correct revised bid form in a printed sealed format shall result in bid rejection.
 - a. Bidders shall submit a printed physical copy of the enclosed revised bid form, this addendum, and all other required documents
 - b. Bids shall be submitted in a sealed envelope prior to deadline according to submittal procedures outlined in the Project Manual. NO ELECTRONIC COPIES WILL BE ACCEPTED.
2. 2-36" R.C. pipes are shown coming into the curb inlet at Sta 19+00 34.5 Lt. with 1-24" RC pipe going out and draining to the creek. I don't think the 24" will handle that flow please clarify. On sheet C-503, the flowline out of the 6-ft curb inlet at Sta. 19+00; 34.5' Lt. should be 1191.19; therefore, stormwater will flow out the proposed 36" RCP to the creek on sheet C-505. Replace Plan Sheets C-503 and X-113, with the attached Plan Sheets C-503 and X-113 (marked Rev. 1 (Addendum No 2).
3. At sta. 12+30 RT to 16+78 RT the plans call for V-Ditch Concrete Paving. At sta. 24+42 RT to 24+90 RT the plans call for Concrete Lined Trapezoidal Ditch. Are these two items of work to be paid for under Item #27-Concrete Channel Paving-500 SY? Quantity for these two items of work is less than bid item. Please clarify? The quantity of 500 SY includes an additional 20% above estimated quantity for use as directed in the field. For the quantity for Concrete Channel Paving, the Unit Price Schedule has been revised to split the v-ditch concrete ditch paving (Sta. 12+30 Rt to Sta 16+78 Rt) from the concrete ditch paving with vertical walls (Sta, 24+42 RT to Sta. 24+90 Rt). Replace Plan Sheet C-505 with the attached Plan Sheet C-505 (marked Rev. 1 (Addendum No 2). Replace Bid Form Pages 00400-4 to 00400-10 with the attached Pages 00400-4 to 00400-10 (marked Addendum No .2)
4. Replace Special Provision page SP-14-3 with the attached page SP-14-3 (marked Addendum No 2).
5. Is an Excel bid form available for this project? An Excel bid form is not available for this project. Bidders must complete the form provided in the Project Manual.

DOCUMENT 00400 –BID FORM (continued)

other Bidder to submit a false or sham bid; Bidder has not solicited or induced any person, firm, or a corporation to refrain from bidding; and Bidder has not sought by collusion to obtain for himself any advantage over any other Bidder or over Owner.

- L. Bidder will perform the Work in compliance with all applicable trench safety standards set forth in Occupational Safety and Health Administration (OSHA) Part 1926 – Subpart P – Excavations.

ARTICLE 4 - BID PRICE

Bidder will complete the Work in accordance with the Contract Documents for the following price(s):

ITEM NO.	CITY SPEC. NO.	DESCRIPTION	UNIT	ESTIMATED QUANTITY	UNIT PRICE	BID AMOUNT
1	111	Roadway Construction Control	LS	1		
2	112	Trench and Excavation Safety Systems	LS	1		
3	201	Clearing, Grubbing, and Demolition	LS	1		
4	SP-14	Unclassified Excavation (Plan Quantity)	CY	11,824		
5	SP-14	Embankment Construction (Plan Quantity)	CY	33,167		
6	SP-14	Undercut Excavation	CY	2,000		
7	SP-14	Rock Excavation	CY	500		
8	203	Subgrade Preparation (Plan Quantity)	SY	10,238		
9	204	4" Topsoil Placement (Yard Areas)	SY	29,205		
10	205	Undercut and Stone Backfill	Ton	5,000		
11	301	18" Class III R.C. Pipe	LF	295		
12	301	24" Class III R.C. Pipe	LF	274		
13	301	30" Class III R.C. Pipe	LF	831		
14	301	36" Class III R.C. Pipe	LF	786		

DOCUMENT 00400 – BID FORM (continued)

15	301	53"x34" Class III R.C. Elliptical Pipe	LF	229
16	301	18" R.C. Flared End Section	EA	8
17	301	24" R.C. Flared End Section	EA	5
18	301	53"x34" R.C. Elliptical Flared End Section	EA	1
19	302	4' Drop Inlet (Type MO)	EA	1
20	302	5' Drop Inlet (Type MO)	EA	5
21	302	6' Drop Inlet (Type MO)	EA	2
22	302	5' Junction Box (Type MO)	EA	3
23	302	4' Drop Inlet Extension	EA	8
24	302	8' Drop Inlet Extension	EA	8
25	302	12' Drop Inlet Extension	EA	1
26	305	Channel Excavation (Plan Quantity)	CY	1,270
27	305	Concrete Channel Paving	SY	440
28	305	Erosion Control Fabric	SY	3,500
29	401	4" Aggregate Base Course	SY	3,127
30	401	8" Aggregate Base Course	SY	10,238
31	403	Asphalt Concrete Hot Mix Binder Course (ACHMBC)	Ton	2,250
32	403	Asphalt Concrete Hot Mix Surface Course (ACHMSC)	Ton	1,200
33	405	Asphalt Concrete Hot Mix Patching for Maintenance of Traffic	Ton	100
34	501	Concrete Curb and Gutter	LF	5,687
35	502	4" Thick Concrete Sidewalk	SY	1,158
36	502	6" Thick Concrete Sidewalk	SY	10
37	503	Concrete Driveway Aprons	SY	77
38	503	Asphalt Driveway	SY	1,161
39	503	Aggregate Base Course Driveway	SY	183
40	505	Seeding and Mulching	Acre	11.0
41	505	Solid Sod	SY	5,900

DOCUMENT 00400 – BID FORM (continued)

42	505	Additional Watering	MG	700
43	506	Mailbox Supports (single)	EA	3
44	506	Mailboxes	EA	3
45	507	4" Pavement Marking (Thermoplastic)	LF	9,250
46	507	6" Pavement Marking (Thermoplastic)	LF	743
47	507	12" Pavement Marking (Thermoplastic)	LF	724
48	507	Pavement Symbols (Yield Line) (Thermoplastic)	SF	12
49	507	Pavement Symbols (Arrow) (Thermoplastic)	EA	15
50	507	Pavement Symbols (ONLY) (Thermoplastic)	EA	12
51	507	4" Pavement Marking (Reflectorized Paint)	LF	849
52	507	Pavement Marking Removal	SF	196
53	508	Street Sign Installation	EA	16
54	509	Erosion Control	LS	1
55	510	Traffic Control and Maintenance	LS	1
56	511	Mobilization (not to exceed 5% of contract price)	LS	1
57	512	Barbed Wire Fence	LF	2,119
58	512	Wood Privacy Fence	LF	200
59	512	Gates for Wood Privacy Fence	LF	20
60	512	Temporary Fencing	LF	2,119
61	513	Cast-in-Place Detectable Warning Panel	SF	118
62	513	Handicap Access Ramp	SY	87
63	514	Project Sign	EA	2
64	516	Cold Milling Asphalt Pavement	SY	1,600
65	517	Tree Protection Fencing	LF	400
66	SP-3	Trail Sign Installation	EA	1
67	SP-4	Concrete Island	SY	197
68	SP-5	4" Thick Concrete Trail	SY	2,614

DOCUMENT 00400 –BID FORM (continued)

69	SP-5	6" Thick Concrete Trail	SY	20
70	SP-6	Gravity Block Retaining Wall #1 (Plan Quantity)	SF	341
71	SP-6	Gravity Block Retaining Wall #2 (Plan Quantity)	SF	2,546
72	SP-6	Gravity Block Retaining Wall #3 (Plan Quantity)	SF	4,701
73	SP-6	Gravity Block Retaining Wall #4 (Plan Quantity)	SF	6,018
74	SP-7	Pipe Underdrain	LF	800
75	SP-9	5'x5' Special Deep Drop Inlet	EA	4
76	SP-9	7'x7' Special Deep Drop Inlet	EA	1
77	SP-9	4'x5' Reverse Throat Inlet	EA	3
78	SP-9	Modify Existing 5' Deep Drop Inlet	EA	1
79	SP-12	Decorative Fence	LF	1,600
80	SP-13	Decorative Gravel (6" Depth)	SY	356
81	SP-16	Bridge Construction Control	LS	1
82	SP-16	Unclassified Excavation for Structures - Bridge	CY	409
83	SP-16	Rock Excavation for Structures - Bridge	CY	97
84	SP-16	Class S Concrete - Bridge	CY	495
85	SP-16	Class S(AE) Concrete - Bridge	CY	410
86	SP-16	Class 2 Protective Surface Treatment	SY	1,717
87	SP-16	Reinforcing Steel - Bridge (Grade 60)	LB	55,570
88	SP-16	Epoxy Coated Reinforcing Steel (Grade 60)	LB	120,670
89	SP-16	Transitional Approach Railing	EA	4
90	SP-16	Structural Steel in Plate Girder Spans (M270-GR. 50W)	LB	373,280
91	SP-16	Elastomeric Bearings	CUIN	12,192
92	SP-16	Silicone Joint Sealant	LF	141
93	SP-16	Filter Blanket	SY	262
94	SP-16	Dumped Riprap	CY	272
95	SP-17	Steel Piling (HP12X53)	LF	165

DOCUMENT 00400 – BID FORM (continued)

96	SP-18	Metal Bridge Railing (Type H2)	LF	179
97	SP-19	Preboring	LF	110
98	SP-20	Textured Coating Finish	SY	393
99	305	<u>Concrete Channel Paving with Vertical Retaining Walls</u>	<u>SY</u>	<u>60</u>
U1	1000	Construction Staking for Water & Sewer	LS	1
U2	1000	Traffic Control and Maintenance for Water & Sewer	LS	1
U3	1000	Wastewater Bypass Pumping	LS	1
U4	1000	Bonds & Insurance	LS	1
U5	2000	Trench and Excavation Safety Systems for Water & Sewer	LS	1
U6	2100	Erosion Control for Water & Sewer	LS	1
U7	2100	Dewatering	LS	1
U8	2100	Mitigation Dam	EA	2
U9	2200	Clearing, Grubbing, and Demolition for Water & Sewer	LS	1
U10	2300	Undercut and Backfill for Water & Sewer	CY	50
U11	2300	Rock Excavation for Water & Sewer	CY	500
U12	2300	Flowable Fill for Abandoned Pipelines	LF	1,435
U13	2300	Backfill Density Test	EA	10
U14	3000	Sewer Service Line	LF	50
U15	3000	Connect Sewer Service	EA	1
U16	3000	10" PVC Sewer Line	LF	239
U17	3300	4' ID Manhole, 0' to 6' Depth	EA	3
U18	3300	4' ID Manhole Additional Depth, Over 6'	VF	6
U19	3300	Demolish Existing Manhole	EA	1
U20	S18	Reinforced Flexible Coupling	EA	1
U21	3300	Modify Sewer Invert	EA	1
U22	3400	24" Bored Steel Encasement for Water Line	LF	135

DOCUMENT 00400 – BID FORM (continued)

U23	4000	Fire Hydrant Assembly	EA	2
U24	4000	12" Ductile Iron Water Line (Class 350)	LF	1,840
U25	4000	8" Ductile Iron Water Line (Class 350)	LF	95
U26	4000	Ductile Iron Fittings	LB	1,865
U27	4000	12" x 12" Tapping Sleeve & Valve	EA	2
U28	4000	12" Gate Valve	EA	1
U29	4000	Water Meter Setting	EA	2
U30	4000	Water Service Line	LF	172
U31	4100	Cut & Cap Existing 6" AC Water Line	EA	4
U32	4100	Cut & Cap Existing 12" PVC Water Line	EA	1
U33	5200	Concrete Test	EA	2
U34	S11	Core Drill & Connect to Existing Manhole	EA	1
U35	S12	Adjust Existing Manhole to Finished Grade	EA	1
U36	S13	Abandon Existing Manhole	EA	1
U37	W20	2" Blowoff Assembly	EA	1
U38	4100	Adjust Existing Valve Box to Finished Grade	EA	2
U39	3400	24" Open Cut Steel Encasement for Water Line	LF	71

SUB TOTAL AMOUNT BID FOR ROADWAY*

\$ _____

*Total amount for items 1 to 99 listed above

SUB TOTAL AMOUNT BID FOR WATER
AND SANITARY SEWER LINES**

\$ _____

**Total amount for items U1 to U39 listed above

DOCUMENT 00400 –BID FORM (continued)

TOTAL AMOUNT BID***

\$ _____

***Total bid amount for all bid items listed above and total of subtotals
listed above

Award will be to a single contractor based on the total amount bid. Bidders shall submit a bid for all line items.

ARTICLE 5 - CONTRACT TIMES

- 5.01 Bidder agrees that the Work will be substantially completed and completed and ready for final payment within the number of calendar days indicated in the Agreement.
- 5.02 Bidder accepts the provisions of the Agreement as to liquidated damages in the event of failure to complete the Work within the times specified in the Agreement.

ARTICLE 6 - BID CONTENT

- 6.01 The following documents are attached to and made a condition of this Bid:
 - A. Required Bid security in the form of a certified or bank cashier's check or a Bid Bond and in the amount of _____ Dollars (\$_____).
 - B. A tabulation of Subcontractors and other persons and organizations required to be identified in this Bid.

Specifications.

~~Preparation of subgrade will not be measured for separate payment, but shall be considered subsidiary to "UNCLASSIFIED EXCAVATION."~~

Imported material for fill or backfill under pavements should be an approved low-plasticity sandy clay (CL), clayey sand (SC), gravelly clay (CL), silt gravel (GM) or clay gravel (GC) having a liquid limit less than 45. The suitability of locally available "hillside" silt/clay gravel (GC or GM) having a liquid limit greater than 45 should be evaluated by the Engineer on a case by case basis. All fill should be free of organic matter, debris and durable rock fragments in excess of about 3-inch dimension. Utility trenches shall be backfilled with crushed aggregate base (ArDOT Standard Specifications Section 303, Class 7) or flowable fill (ArDOT Standard Specifications Section 206).

Subgrade soils under pavement shall be select fill material consisting of approved low-plasticity sandy clay (CL), clayey sand (SC), gravelly clay (CL), silt gravel (GM) or clay gravel (GC) having a liquid limit less than 45. The suitability of locally available "hillside" silt/clay gravel (GC or GM) having a liquid limit greater than 45 should be evaluated by the Engineer on a case by case basis.

Subgrade soils with a liquid limit greater than 40 or a plasticity index greater than 15 shall be undercut to a depth determined by the Engineer and removed from the street section or improved by a designed method of stabilization accepted by the City Engineer. Other soils which the Engineer determines cannot be properly compacted shall also be undercut to a specified depth. This excavated unsuitable material shall be disposed of off-site.

Backfill for undercut areas shall meet the requirements described above. Other materials exceeding these requirements may be used as backfill, subject to the approval of the Engineer. Backfill shall be placed and compacted in 8-inch maximum lifts in accordance with the density requirements in this specification.

SP-14-4.5 The ditch excavation for channel changes or to bring ditches to minimum required section shall be in accordance with applicable portions of the Standard Specifications referred to above. All ditch excavation shall be completed to the required grade shown on the Plans or as directed by the Engineer.

SP-14-4.6 OVER-EXCAVATION: Where excavation is carried below or beyond that required, the space shall be filled to grade with suitable material and thoroughly compacted as directed by the Engineer. The Contractor will not be entitled to additional compensation for such over-excavation or the necessary refilling, unless the Owner or its representative is responsible for the error.

SP-14-4.7 Those areas outside of the pavement areas in which the top layer of soil material has become compacted, by hauling or other activities of the Contractor, shall be scarified and disked to a depth of 4 inches, in order to loosen and pulverize the soil.

SP-14-4.8 If it is necessary to interrupt existing surface drainage, sewers or under-drainage, conduits, utilities, or similar underground structures, the Contractor shall be responsible for and shall take all necessary precautions to preserve them or provide temporary services. When such facilities are encountered, the Contractor shall notify the Engineer, who shall arrange for their removal if

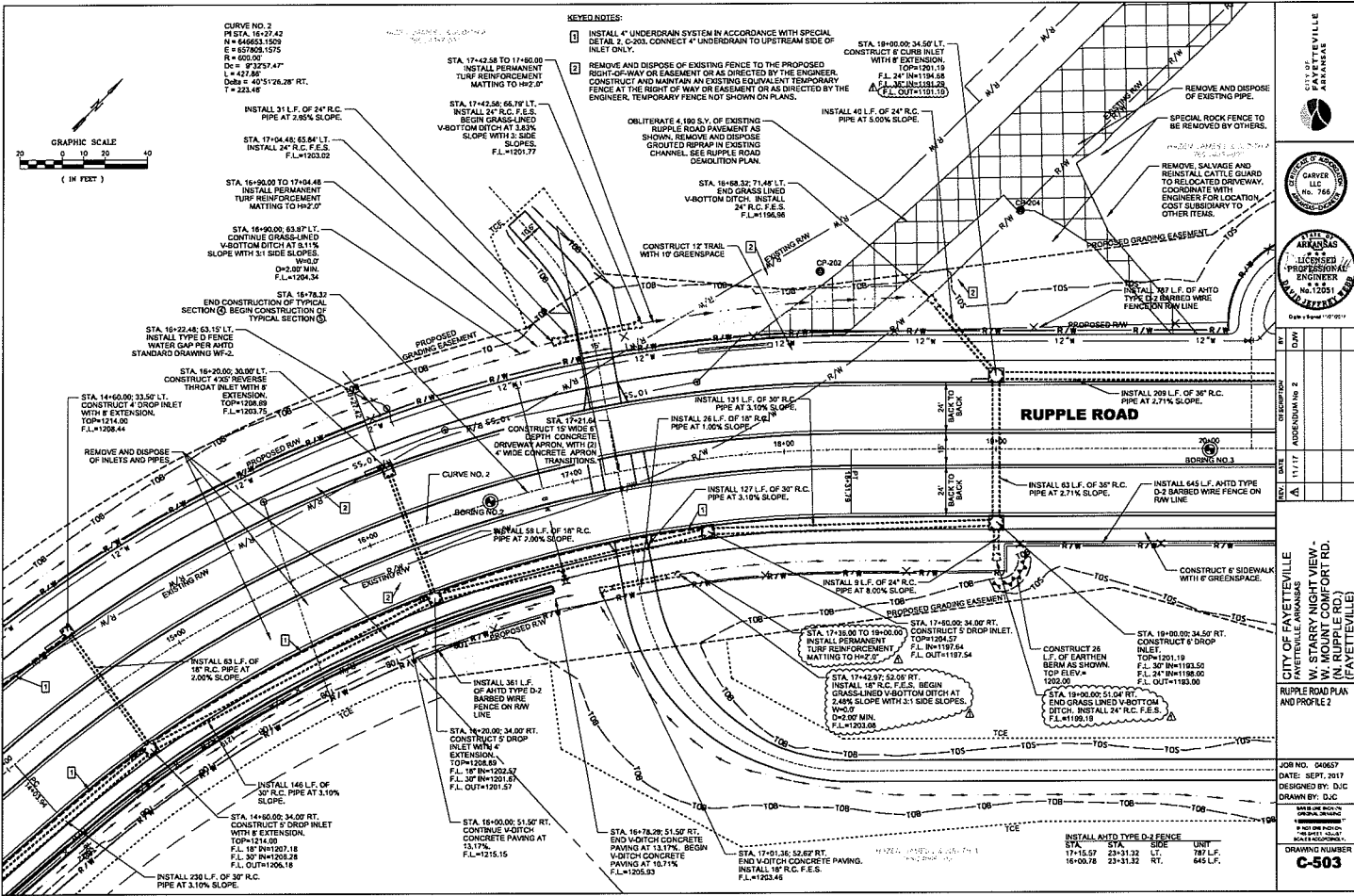

CITY OF FAYETTEVILLE
PLANNING DEPARTMENT

CARVER
LIC. NO. 748

ARRELLAS
LICENSED PROFESSIONAL ENGINEER
No. 12051

CITY OF FAYETTEVILLE
FAYETTEVILLE, ARKANSAS
W. STARRY NIGHT VIEW - RUPPEL RD.
(FAYETTEVILLE)

RUPPEL ROAD PLAN AND PROFILE 2

JOB NO. 040657
DATE: SEPT. 2017
DESIGNED BY: D.J.C.
DRAWN BY: D.J.C.

DRAWING NUMBER
C-503

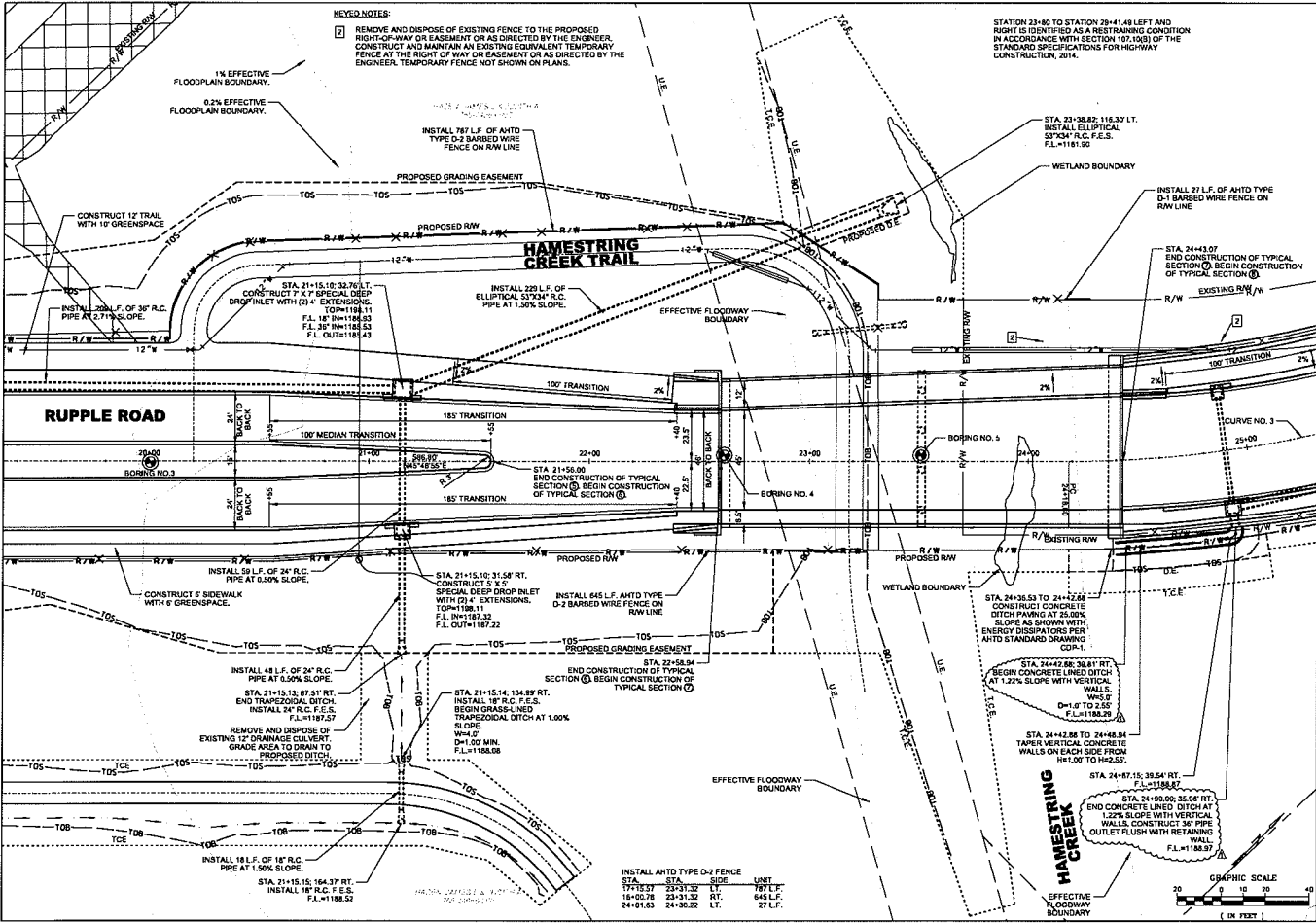

KEY NOTES:

1 REMOVE AND DISPOSE OF EXISTING FENCE TO THE PROPOSED RIGHT-OF-WAY OR EASEMENT OR AS DIRECTED BY THE ENGINEER. CONSTRUCT AND MAINTAIN AN EXISTING EQUIVALENT TEMPORARY FENCE AT THE RIGHT OF WAY OR EASEMENT OR AS DIRECTED BY THE ENGINEER. TEMPORARY FENCE NOT SHOWN ON PLANS.

STATION 23+80 TO STATION 24+148 LEFT AND RIGHT IS IDENTIFIED AS A RESTRAINING CONDITION IN ACCORDANCE WITH SECTION 107.10(3) OF THE STANDARD SPECIFICATIONS FOR HIGHWAY CONSTRUCTION, 2014.

PROJECT NO.	2017-0007
DATE	11/17/17
ADDENDUM NO. 2	
DATE	
DESCRIPTION	
BY	
DATE	

CITY OF FAYETTEVILLE
 W. STARRY NIGHT VIEW -
 N. MONTE COMFORT RD.
 RUPPEL ROAD PLAN
 AND PROFILE 1
 (FAYETTEVILLE)

JOB NO. 04657
 DATE: SEPT. 2017
 DESIGNED BY: DJC
 DRAWN BY: DJC

DRAWING NUMBER
C-505

STA.	STA.	SIDE	UNIT
17+15.27	24+31.32	LT.	787 LF.
18+00.78	24+31.32	RT.	642 LF.
24+01.63	24+30.22	LT.	27 LF.

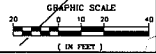

11/17/2017 1:51:13 PM
 C:\Users\jmc\Documents\111717\111717.dwg
 111717.dwg

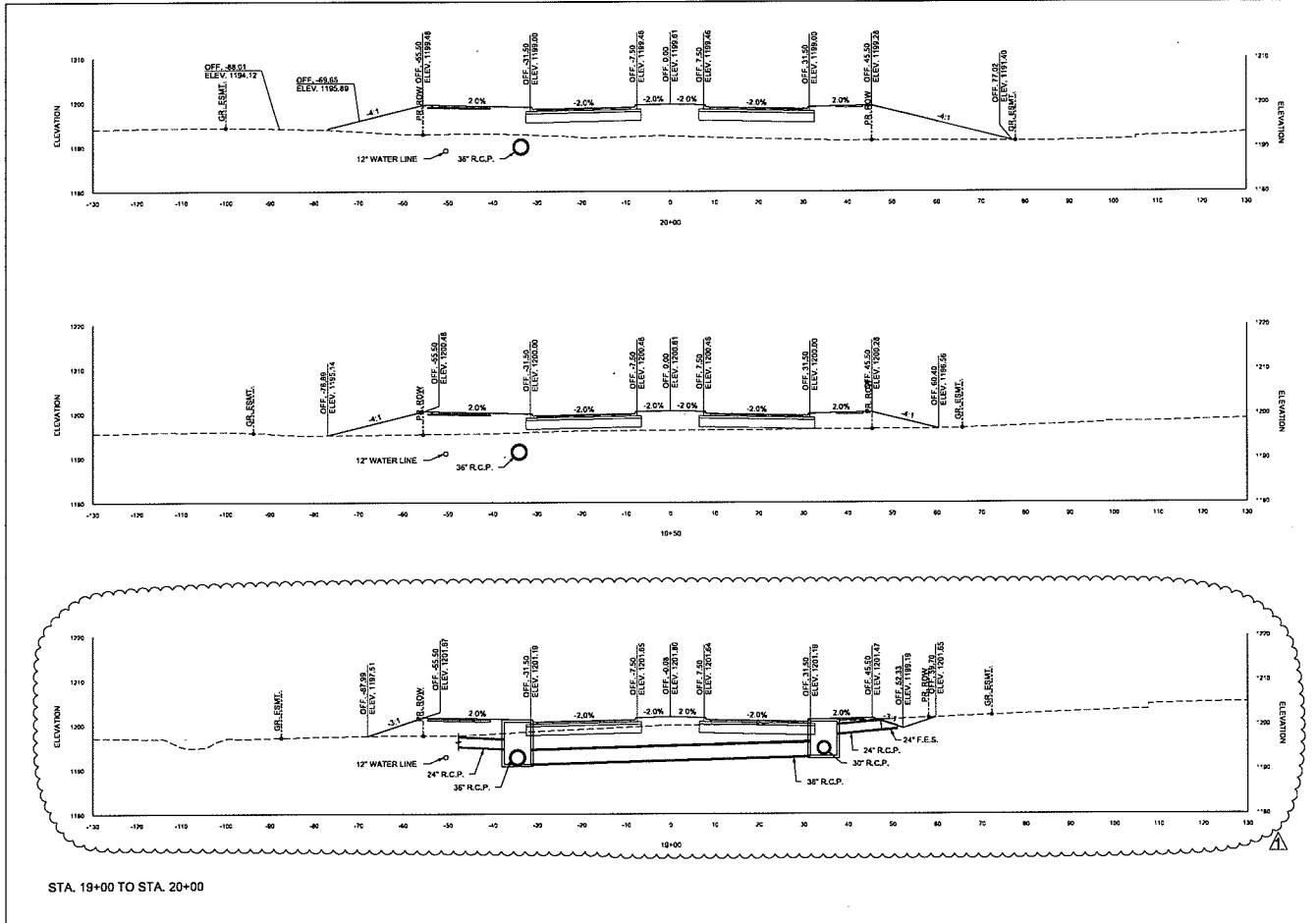

CITY OF FAYETTEVILLE
 FAYETTEVILLE, ARKANSAS

STATE OF ARKANSAS
 REGISTERED PROFESSIONAL ENGINEER
 J. M. GARDNER
 No. 746

DATE: SEPT. 2017
 DESIGNED BY: DJC
 DRAWN BY: DJC

CROSS SECTIONS 13

JOB NO. 040657
 DATE: SEPT. 2017
 DESIGNED BY: DJC
 DRAWN BY: DJC

DRAWING NUMBER
X-113

Bid 17-67, Addendum 3

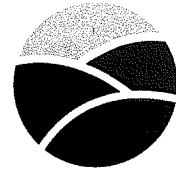

CITY OF
FAYETTEVILLE
ARKANSAS

Date: Wednesday, November 22, 2017

To: All Prospective Vendors

From: Les McGaugh – 479.575.8220 – lmcgaugh@fayetteville-ar.gov

RE: Bid 17-67, Construction – Starry Night View to Mt. Comfort (Ripple Rd)

This addendum is hereby made a part of the contract documents to the same extent as though it were originally included therein. Bidders should indicate their receipt of same in the appropriate blank of the Bid Form. **BIDDERS SHOULD ACKNOWLEDGE THIS ADDENDUM ON THE DESIGNATED LOCATION ON THE BID FORM.**

1. On page C-101, for typical section 1, it is showing leveling with binder (PG 70-22), is this correct? It will be tough to level with binder. This is a typo for the leveling course. It should read (1/2") instead of (1"). The leveling course will be paid for under Asphalt Concrete Hot Mix Surface Course (ACHMSC) - Pay Item No. 32. Replace sheet C-101 in the Plans with the attached sheet C-101 (marked Revision 1 – Addendum No. 3)

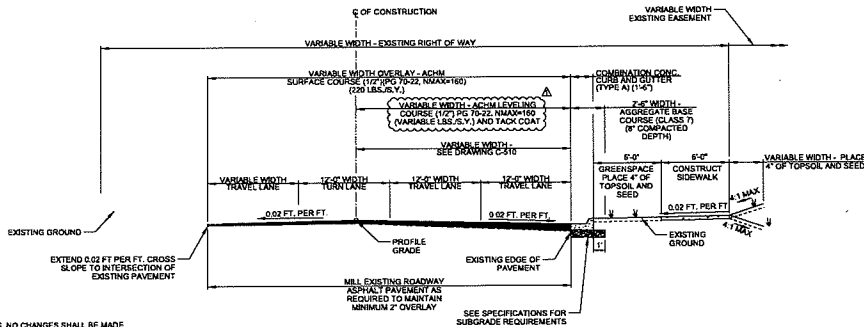

TYPICAL SECTION GENERAL NOTES

1. REFER TO CROSS SECTIONS FOR DEVIATIONS FROM NORMAL SLOPES. NO CHANGES SHALL BE MADE FROM THE PLANNED SLOPES WITHOUT THE APPROVAL OF THE ENGINEER.
2. THE FINAL LIFT OF SURFACE COURSE IS TO BE PLACED AFTER ALL OTHER COURSES HAVE BEEN LAID. LONGITUDINAL JOINTS SHALL BE AT THE LANE LINES.
3. PRIOR TO AND DURING PLACEMENT OF PAVEMENT IN FRONT OF THE CURB AND GUTTER, THE CONTRACTOR SHALL PROVIDE POSITIVE DRAINAGE AT ALL TIMES. THE METHODS USED SHALL BE APPROVED BY THE ENGINEER. PAYMENT FOR THIS WORK SHALL BE CONSIDERED INCLUDED IN THE PRICE BID FOR THE VARIOUS CONTRACT ITEMS.
4. THE THICKNESS OF AGGREGATE BASE COURSE SHALL BE WITHIN PLUS OR MINUS ONE INCH OF THE PLAN THICKNESS SHOWN. THE CONTRACTOR WILL CORRECT ANY DEFICIENT THICKNESS THAT DOES NOT MEET TOLERANCE INDICATED. PAYMENT WILL NOT BE MADE FOR MATERIAL PLACED IN EXCESS OF THE TOLERANCE INDICATED.
5. TRANSVERSE EXPANSION JOINTS SHALL BE PLACED IN CONCRETE WALKS AT 50' INTERVALS.
6. THE EXISTING ASPHALT PAVEMENT TO BE REMOVED FROM THE REMAINING PAVEMENT SHALL BE SEPARATED BY SAWING ALONG A NEAT LINE. AFTER SAWING, THE PAVEMENT TO BE REMOVED SHALL BE CAREFULLY REMOVED IN A MANNER THAT WILL NOT DAMAGE THE PAVEMENT THAT IS TO REMAIN. ANY DAMAGE TO THE ASPHALT PAVEMENT THAT IS TO REMAIN IN PLACE SHALL BE REPAIRED AT THE CONTRACTOR'S EXPENSE.

OVERLAY 4 LANE CURB AND GUTTER (RIGHT SIDE ONLY) WITH NO MEDIAN (1)

RUPPLE ROAD: STA. 10+70.00 TO STA. 11+08.45

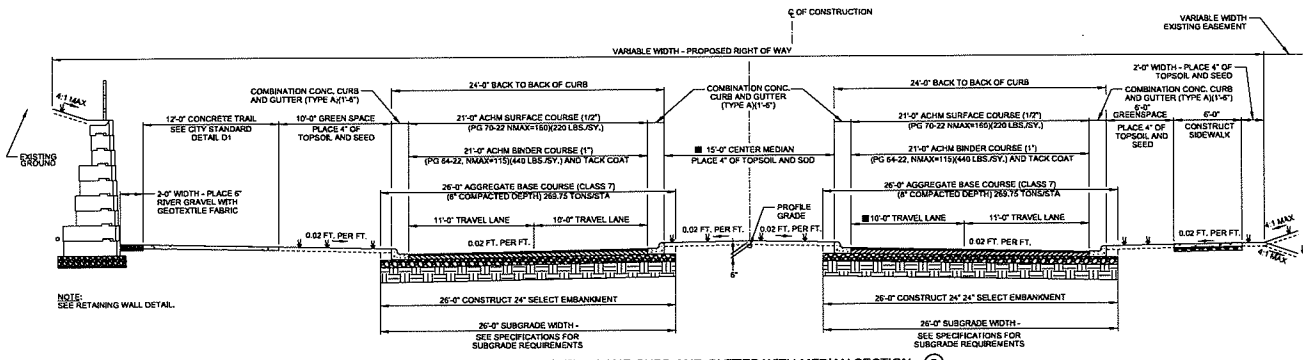

FULL DEPTH 4 LANE CURB AND GUTTER WITH MEDIAN SECTION (2)

RUPPLE ROAD: STA. 11+08.45 TO STA. 12+00.15
 STA. 11+08.45 TO STA. 12+00.15 VARIABLE WIDTH

CITY OF FAYETTEVILLE
 ARKANSAS

CITY ENGINEER
 JAMES H. HARRIS

CITY OF FAYETTEVILLE
 ARKANSAS
 LICENSE NO. 786

CITY OF FAYETTEVILLE
 ARKANSAS
 LICENSE NO. 11251

CITY OF FAYETTEVILLE
 ARKANSAS
 LICENSE NO. 11251

REV.	DATE	DESCRIPTION
1	11/20/11	ADDENDUM #3

CITY OF FAYETTEVILLE
 ARKANSAS
 W. STARRY NIGHT VIEW -
 W. MOUNT COMFORT RD.
 (FAYETTEVILLE)

ROADWAY TYPICAL SECTIONS

JOB NO. 040637
 DATE: SEPT. 2017
 DESIGNED BY: DJC
 DRAWN BY: DJC

DRAWING NUMBER
C-101

DOCUMENT 00500 – AGREEMENT

BETWEEN OWNER AND CONTRACTOR

Contract Name/Title: W. STARRY NIGHT VIEW – W. MOUNT COMFORT RD. (N. RUPPLE RD.)

Contract No.: _____

THIS AGREEMENT is dated as of the _____ day of _____ in the year 20__ by and between The City of Fayetteville, Arkansas and _____.(hereinafter called Contractor).

ARTICLE 1 - WORK

1.01 Contractor shall complete all Work as specified or indicated in the Contract Documents. The work under this Contract includes, but is not limited to:

The Contract consists of approximately 1,800 L.F. of roadway construction with raised median, 182 L.F. of a new bridge, construction of associated earthwork and channelization, curb and gutter, sidewalk, shared use paths (trails), enclosed drainage, retaining walls, fencing, obliterating existing Ruppel Road, driveways, 12 inch waterline and appurtenance, 10 inch sanitary sewer, sanitary sewer manholes, and miscellaneous items.

ARTICLE 2 - ENGINEER

2.01 The Project has been designed by the City of Fayetteville, Engineering Division, who is hereinafter called Engineer. The Engineer assumes all duties and responsibilities, and has the rights and authority assigned to Engineer in the Contract Documents in connection with completion of the Work in accordance with the Contract Documents.

ARTICLE 3 - CONTRACT TIME

3.01 TIME OF THE ESSENCE:

A. All time limits for milestones, if any, Substantial Completion, and completion and readiness for final payment as stated in the Contract Documents are of the essence of the Contract.

DOCUMENT 00500 – AGREEMENT (continued)

3.02 DATES FOR SUBSTANTIAL COMPLETION AND FINAL PAYMENT:

- A. The Work will be Substantially Completed within **300** calendar days after the date when the Contract Times commence to run as provided in the GENERAL CONDITIONS, and completed and ready for final payment in accordance with the GENERAL CONDITIONS within **330** calendar days after the date when the Contract Times commence to run.

3.03 LIQUIDATED DAMAGES:

- A. Owner and Contractor recognize that time is of the essence of this Agreement and that The City of Fayetteville will suffer financial loss if the Work is not completed within the time specified above, plus any extensions thereof allowed in accordance with the GENERAL CONDITIONS. The parties also recognize the delays, expense, and difficulties involved in proving the actual loss suffered by The City of Fayetteville if the Work is not Substantially Completed on time. Accordingly, the City of Fayetteville and Contractor agree that as liquidated damages for delay (but not as a penalty) Contractor shall pay The City of Fayetteville Seven Hundred Fifty Dollars (\$750.00) for each calendar day that expires after the time specified above in Paragraph 3.02 for Substantial Completion until the remainder of the Work is Substantially Complete. After Substantial Completion, if Contractor shall neglect, refuse, or fail to complete the remaining Work within the time specified in Paragraph 3.02 for completion and readiness for final payment or any proper extension thereof granted by The City of Fayetteville, Contractor shall pay The City of Fayetteville Seven Hundred Fifty Dollars (\$750.00) for each calendar day that expires after the time specified for completion and readiness for final payment.

ARTICLE 4 - CONTRACT PRICE

- 4.01 The CITY OF FAYETTEVILLE agrees to pay, and the CONTRACTOR agrees to accept, as full and final compensation for all work done under this agreement, the amount based on the prices bid in the Proposal (BID FORM) which is hereto

DOCUMENT 00500 – AGREEMENT (continued)

attached, for the actual amount accomplished under each pay item, said payments to be made in lawful money of the United States at the time and in the manner set forth in the Specifications.

- 4.02 As provided in the General Conditions estimated quantities are not guaranteed, and determinations of actual quantities and classifications are to be made by ENGINEER as provided in the General Conditions. Unit prices have been computed as provided in the General Conditions.

ARTICLE 5 - PAYMENT PROCEDURES

5.01 SUBMITTAL AND PROCESSING OF PAYMENTS:

- A. Contractor shall submit Applications for Payment in accordance with the GENERAL CONDITIONS. Applications for Payment will be processed by Engineer as provided in the GENERAL CONDITIONS.

5.02 PROGRESS PAYMENTS, RETAINAGE:

- A. The City of Fayetteville shall make progress payments on account of the Contract Price on the basis of Contractor's Applications for Payment as recommended by Engineer, on or about the 15th day of each month during construction. All such payments will be measured by the schedule of values established in the GENERAL CONDITIONS (and in the case of Unit Price Work based on the number of units completed) or, in the event there is no schedule of values, as provided in the General Requirements.
1. Prior to Substantial Completion, progress payments will be made in an amount equal to the percentage indicated below, but, in each case, less the aggregate of payments previously made and less such amounts as Engineer shall determine, or The City of Fayetteville may withhold, in accordance with the GENERAL CONDITIONS.
- a. 95% of Work Completed (with the balance being retainage).

DOCUMENT 00500 – AGREEMENT (continued)

- b. 100% of Equipment and Materials not incorporated in the Work but delivered, suitably stored, and accompanied by documentation satisfactory to The City of Fayetteville as provided in the GENERAL CONDITIONS.
- 2. Upon Substantial Completion, The City of Fayetteville shall pay an amount sufficient to increase total payments to Contractor to 95% of the Contract Price (with the balance being retainage), less such amounts as Engineer shall determine, or The City of Fayetteville may withhold, in accordance with the GENERAL CONDITIONS

5.03 **FINAL PAYMENT:**

- A. Upon final completion and acceptance of the Work in accordance with the GENERAL CONDITIONS, The City of Fayetteville shall pay the remainder of the Contract Price as recommended by Engineer and as provided in the GENERAL CONDITIONS.

ARTICLE 6 - CONTRACTOR'S REPRESENTATIONS

6.01 In order to induce The City of Fayetteville to enter into this Agreement, Contractor makes the following representations:

- A. Contractor has examined and carefully studied the Contract Documents including the Addenda and other related data identified in the Bid Documents.
- B. Contractor has visited the Site and become familiar with and is satisfied as to the general, local, and Site conditions that may affect cost, progress, performance, and furnishing of the Work.
- C. Contractor is familiar with and is satisfied as to all federal, state, and local Laws and Regulations that may affect cost, progress, performance, and furnishing of the Work.

DOCUMENT 00500 – AGREEMENT (continued)

- D. Contractor has carefully studied all:
- (1) reports of explorations and tests of subsurface conditions at or contiguous to the Site and all drawings of physical conditions in or relating to existing surface or subsurface structures at or contiguous to the Site; and
 - (2) reports and drawings of a Hazardous Environmental Condition, if any, at the Site. Contractor acknowledges that The City of Fayetteville and Engineer do not assume responsibility for the accuracy or completeness of information and data shown or indicated in the Contract Documents with respect to Underground Facilities at or contiguous to the Site.
- E. Contractor has obtained and carefully studied (or assumes responsibility of having done so) all such additional supplementary examinations, investigations, explorations, tests, studies, and data concerning conditions (surface, subsurface, and Underground Facilities) at or contiguous to the Site or otherwise which may affect cost, progress, performance, and furnishing of the Work or which relate to any aspect of the means, methods, techniques, sequences, and procedures of construction to be employed by Contractor and safety precautions and programs incident thereto.
- F. Contractor does not consider that any additional examinations, investigations, explorations, tests, studies, or data are necessary for the performing and furnishing of the Work at the Contract Price, within the Contract Times, and in accordance with the other terms and conditions of the Contract Documents.
- G. Contractor is aware of the general nature of work to be performed by The City of Fayetteville and others at the Site that relates to the Work as indicated in the Contract Documents.
- H. Contractor has correlated the information known to Contractor, information and observations obtained from visits to the Site, reports and drawings

DOCUMENT 00500 – AGREEMENT (continued)

identified in the Contract Documents, and all additional examinations, investigations, explorations, tests, studies, and data with the Contract Documents.

- I. Contractor has given Engineer written notice of all conflicts, errors, ambiguities, or discrepancies that Contractor has discovered in the Contract Documents and the written resolution thereof by Engineer is acceptable to Contractor.
- J. The Contract Documents are generally sufficient to indicate and convey understanding of all terms and conditions for performance and furnishing of the Work.

DOCUMENT 00500 – AGREEMENT (continued)

ARTICLE 7 - CONTRACT DOCUMENTS

7.01 CONTENTS:

- A. The Contract Documents which comprise the entire Agreement between The City of Fayetteville and Contractor concerning the Work consist of the following and may only be amended, modified, or supplemented as provided in the GENERAL CONDITIONS:
 - 1. This Agreement.
 - 2. Exhibits to this Agreement (enumerated as follows):
 - a. Notice to Proceed.
 - b. Contractor's Bid.
 - c. Documentation submitted by Contractor prior to Notice of Award.
 - d. Federal funding documentation
 - 3. Performance, Payment, and other Bonds.
 - 4. General Conditions.
 - 5. Supplementary Conditions.
 - 6. Specifications consisting of divisions and sections as listed in table of contents of Project Manual.

DOCUMENT 00500 – AGREEMENT (continued)

7. Drawings consisting of a cover sheet and sheets as listed in the table of contents thereof, with each sheet bearing the following general title:

W. STARRY NIGHT VIEW – W. MOUNT COMFORT RD. (N. RUPPLE RD.)

8. Addenda numbers one (1) to _____ (___), inclusive.
9. The following which may be delivered or issued after the Effective Date of the Agreement and are not attached hereto: All Written Amendments and other documents amending, modifying, or supplementing the Contract Documents pursuant to the GENERAL CONDITIONS.

ARTICLE 8 - MISCELLANEOUS

8.01 TERMS:

- A. Terms used in this Agreement which are defined in the GENERAL CONDITIONS shall have the meanings stated in the GENERAL CONDITIONS.

8.02 ASSIGNMENT OF CONTRACT:

- A. No assignment by a party hereto of any rights under or interests in the Contract Documents will be binding on another party hereto without the written consent of the party sought to be bound; and specifically but without limitation, moneys that may become due and moneys that are due may not be assigned without such consent (except to the extent that the effect of this restriction may be limited by Law), and unless specifically stated to the contrary in any written consent to an assignment, no assignment will release or discharge the assignor from any duty or responsibility under the Contract Documents.

DOCUMENT 00500 – AGREEMENT (continued)

8.03 SUCCESSORS AND ASSIGNS:

- A. The City of Fayetteville and Contractor each binds himself, his partners, successors, assigns, and legal representatives to the other party hereto, its partners, successors, assigns, and legal representatives in respect to all covenants, agreements, and obligations contained in the Contract Documents.

8.04 SEVERABILITY:

- A. Any provision or part of the Contract Documents held to be void or unenforceable under any Law or Regulation shall be deemed stricken, and all remaining provisions shall continue to be valid and binding upon The City of Fayetteville and Contractor, who agree that the Contract Documents shall be reformed to replace such stricken provision or part thereof with a valid and enforceable provision that comes as close as possible to expressing the intention of the stricken provision.

OTHER PROVISIONS: Not Applicable.

IN WITNESS WHEREOF, The City of Fayetteville and Contractor have signed this Agreement in quadruplicate. One counterpart each has been delivered to Contractor and Engineer. Two counterparts each has been delivered to The City of Fayetteville. All portions of the Contract Documents have been signed, initialed, or identified by The City of Fayetteville and Contractor or identified by Engineer on their behalf.

DOCUMENT 00500 – AGREEMENT (continued)

This Agreement will be effective on _____, 20__, which is the Effective Date of the Agreement.

CONTRACTOR _____

CITY OF FAYETTEVILLE _____

By: _____

By: _____

Title: _____

Title: _____

(SEAL)

(SEAL)

Attest _____

Attest _____

Address for giving notices

Address for giving notices

License No. _____

(attach evidence of authority to sign and resolution or other documents authorizing execution of Agreement)

Agent for Service of process

(If Contractor is a corporation, attach evidence of authority to sign.)

Approved As to Form:

By: _____

Attorney For: _____

END OF DOCUMENT 00500



NORTHWEST ARKANSAS REGIONAL PLANNING COMMISSION

1311 Clayton St., Springdale, Arkansas, 72762

• (479) 751 7125

• Fax: (479) 751 7150

• <http://nwarpc.org>

November 8, 2017

Mayor Lioneld Jordan
City of Fayetteville
113 West Mountain Street
Fayetteville, AR 72701

RECEIVED

NOV 13 2017

CITY OF FAYETTEVILLE
MAYOR'S OFFICE

Re: ARDOT Job No. 040657 Ruppel Road - W. Starry Night View to W. Mount Comfort Road
Construction Phase
FFY 2018 Surface Transportation Block Grant Program - Attributable (STBGP-A)

Dear Mayor Jordan:

The Ruppel Road Project -Construction Phase was selected by the Northwest Arkansas Regional Planning Commission on September 23, 2015 for FFY 2017 STBGP-A funding and again on September 27, 2017 for FFY 2018 STBGP-A funding. Please note the actual funds awarded/obligated for FFY 2017 funding increased by \$774,401 for a total of 3,262,401 (See attached Federal-Aid Project Agreement).

The NWARPC approved an additional \$1,545,599 from FY 2018 funds for a total of \$5,774,303 in federal STBGP-A funds for Ruppel Road. The 2013 to 2017 and 2018 STBGP-A funds awarded are shown below:

	2013-2017	2018	Total Amount STBGP-A
STBGP-A	\$4,228,704	\$1,545,599	\$5,774,303 (Federal)

The STBGP-A funding is subject to an obligation limitation and the total available funds may change after final FFY 2018 funding is published.

All required AHTD submittals and required approvals for this project should be completed by August 15, 2018 in order to allow sufficient time to obligate the STBGP-A funds for this project by September 30, 2018.

Please let us know if you have any questions or need additional information regarding this program.

Sincerely,

Jeff Hawkins

Director

Cc: Mr. Paul Simms, AHTD